

# Lincoln-Ashland-Belmont Section 2 Improvements

## Lincoln Avenue, between Wellington Ave and Melrose St

## Ashland Avenue, between Barry Ave and School St

## Belmont Avenue, between Ashland Ave and Southport Ave

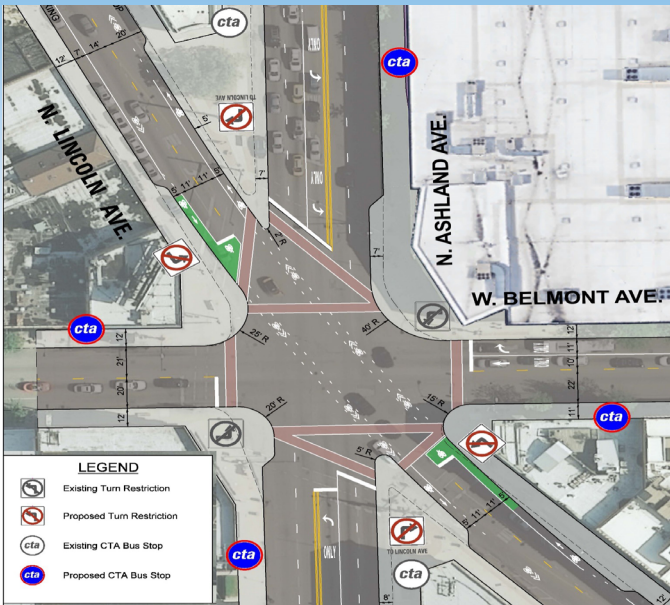

Beginning in Spring 2022, Lincoln Avenue, Ashland Avenue, and Belmont Avenue will be improved as the City renovates these streets with infrastructure improvements and streetscape elements. The project will consist of numerous improvements, including full-width resurfacing, new sidewalks, new lighting and traffic signals, new decorative crosswalks, street trees, community identifiers, and the reconstruction of the plaza on the northeast corner of the Lincoln-Ashland-Belmont intersection incorporating the existing memorial, seating, street trees, landscaping, and pavers.

These improvements have been designed by the City of Chicago Department of Transportation in close cooperation with community representatives and your Aldermen.

### Project Highlights

- New sidewalks with paver parkways
- Full width resurfacing
- New traffic signals with reduced pedestrian crossing distances
- Benches, litter receptacles, and bike racks
- Street trees, hanging baskets, and new landscaping
- Street and pedestrian lighting with LED smart lighting
- Light pole identifiers

### Traffic Impacts

Throughout construction the streets will remain open to motorists and pedestrians and access to businesses will be maintained. In order to keep the street open to traffic, parking will not be allowed in the area of active construction. In addition, there will be periodic parking restrictions on some side streets.

The CTA routes will not be affected. For more information, please call the CTA information hotline at: (all Chicagoland area codes) 836-7000.

**The project is scheduled for substantial completion in Summer 2023. Construction review meetings will be held weekly when construction is under way. The meetings are open to the public and provide residents and businesses the opportunity to ask questions and coordinate concerns regarding construction. The dates, location, and time will be determined prior to construction start.**

For additional information, please call the Department of Transportation at (312) 744-5900, or go to <https://chicagocompletestreets.org/portfolio/lincoln-ashland-belmont/>.

# COMPLETE STREETS

The City of Chicago is committed to building Complete Streets to ensure that everyone – pedestrians, transit users, bicyclists and motorists – can travel safely and comfortably along and across a street. Complete Streets give Chicagoans of all ages and abilities safer, cheaper, and healthier travel options. They support economic development and can incorporate environmental services and placemaking, which helps to create sustainable infrastructure and communities. The Chicago Department of Transportation is working to bring these benefits to your community.



## IMPROVE SAFETY

Complete Streets are better suited for people walking, biking, taking public transit, and driving. Streets are designed to encourage motorists to drive at the posted speed limit, which helps reduce crashes and their severity.

## LOWER TRANSPORTATION COSTS

Americans spend on average 18 cents of every dollar on transportation, with the poorest 20% of families spending more than twice that amount. When residents have the opportunity to walk, bike or take transit, they have more control over their expenses by replacing car trips with these inexpensive options.

## IMPROVE HEALTH

By designing Complete Streets, more residents will have active transportation options such as walking, bicycling, or using public transit. Incorporating trees and landscape improvements helps clean the air, capture stormwater, and keep the city cool. Complete Streets encourage healthier lifestyles and improve quality of life.

## BUILD STRONGER COMMUNITIES

Complete Streets play an important role in livable communities where all people regardless of age, ability, or mode of transportation, feel safe and welcome on the streets. A safe walking and bicycling environment with places for people to gather are an essential part of creating friendly, walkable communities.

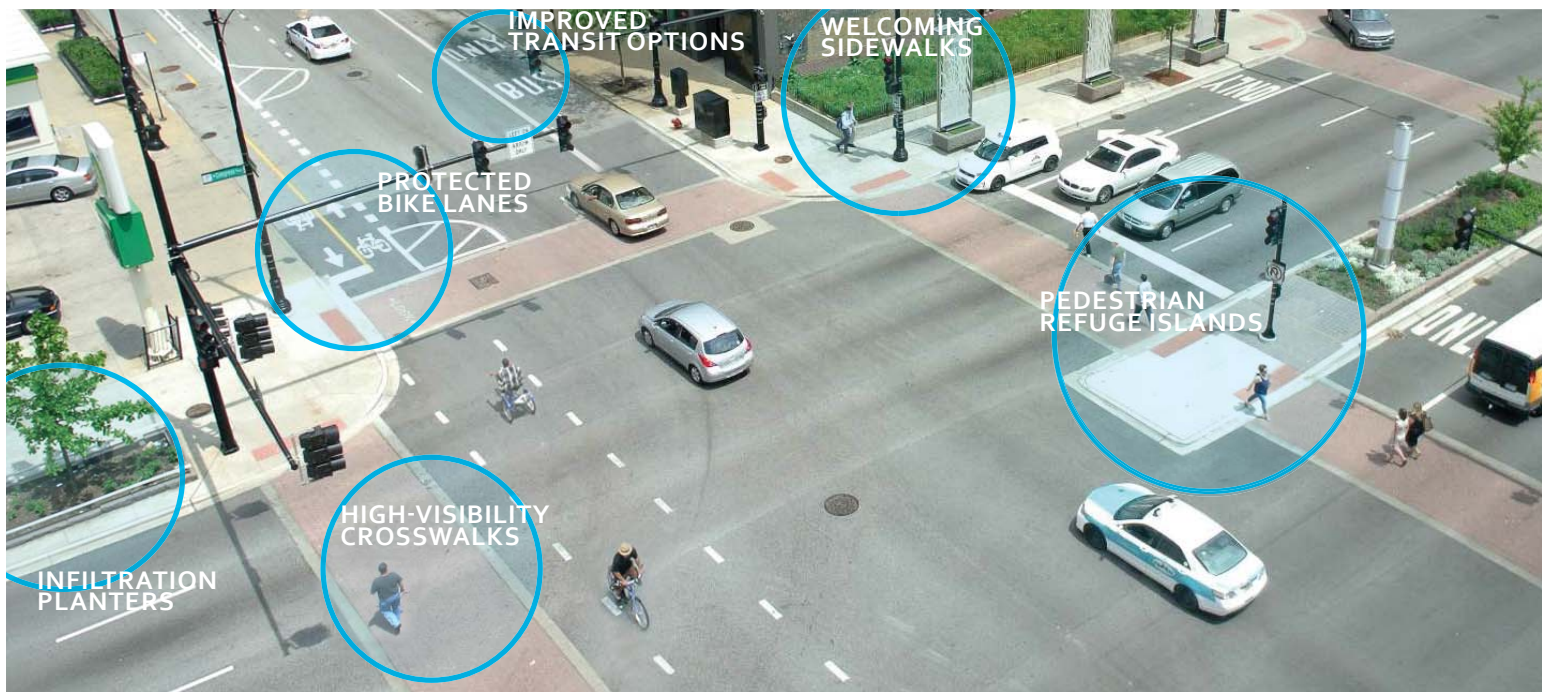

Chicago's Complete Streets guidelines and policy are outlined in the *Complete Streets Chicago: Design Guidelines*.

For additional information, please call the Department of Transportation at (312) 744-5900, email [cdotnews@cityofchicago.org](mailto:cdotnews@cityofchicago.org), or visit [www.chicagocompletestreets.org](http://www.chicagocompletestreets.org)