



ISW ROSELAND SOUTH MICHIGAN AVENUE & 111TH STREET IMPROVEMENTS

Community Meeting #2

- 01** Introductions
- 02** Project Scope & Schedule
- 03** Project Vision and Principals
- 04** Project Safety Features
- 05** Community Survey Results
- 06** Concept Designs
- 07** Next Steps + Q&A



We don't want to **miss** anything!

Please be aware that this presentation will be **recorded** for note taking and record keeping purposes. The recording will be posted online once the meeting is over.

Participation in this presentation acknowledges **consent** of this notification

Everyone working **together!**

- 01 To be respectful of our group, we request everyone remain **MUTED** when not speaking.
- 02 Please use the **CHAT FUNCTION** for any questions
All questions and ideas are valid
- 03
- 04 Respect all other participant opinions and perspectives



9th Ward

- Alderman Anthony Beale

34th Ward

- Alderman Carrie Austin

Chicago Department of Transportation (CDOT)

- Lubica Benak, Program Director
- Alisa Tilson, Project Manager

Infrastructure Engineering (MBE)

Civil Engineering & Project Lead

Upland Design Ltd.(WBE)

Landscape Architecture & Community Engagement

Environmental Design International (MBE)

Surveying

Wang Engineering, Inc. (MBE)

Geotechnical and Environmental

TranSmart, Inc. (WBE)

Engineering

Peralte-Clark (MBE)

Engineering

PROJECT OVERVIEW

Supports the Invest South/West initiative to re-activate neighborhood cores that have historically served as focal points for pedestrian activity, shopping, services, transportation, public spaces and quality-of-life amenities for residents.

Part of Chicago Works: Mayor Lori E. Lightfoot's five-year capital plan that will Invest in Communities Through Infrastructure.

The streetscapes consist of infrastructure, pedestrian safety, and placemaking improvements with the goal of creating a unified, safe, walkable, and attractive commercial destination. The streetscape projects are comprehensive and include ROW improvements from building face to building face.

The Project Includes:

- Public Outreach
- Placemaking and urban design strategy
- Concept design & engineering
- Detailed design & engineering
- Construction of the corridor



PROJECT PURPOSE AND SCOPE



PROJECT SCOPE

S. Michigan Ave. from 110th St. to 116th St.
and 111th St. from 111th Red Line Station. to MLK
Alderman Beale, Ward 9 / Alderman Austin, Ward 34

Roadway Improvements

- Roadway geometry and intersection improvements
- Full width resurfacing
- Drainage improvements
- Sidewalk, curb, and gutter
- Signal upgrades

Pedestrian Area Improvements

- ADA ramps and crosswalks
- Curb extensions
- Street lighting
- Improved pavement markings and signage
- Site furniture and seating areas
- Tree planting and landscaping
- Side street improvements to the alleys as needed

Other Features

- Community identifiers
- Light pole identifiers



PROJECT SCOPE & SCHEDULE

WE ARE
HERE

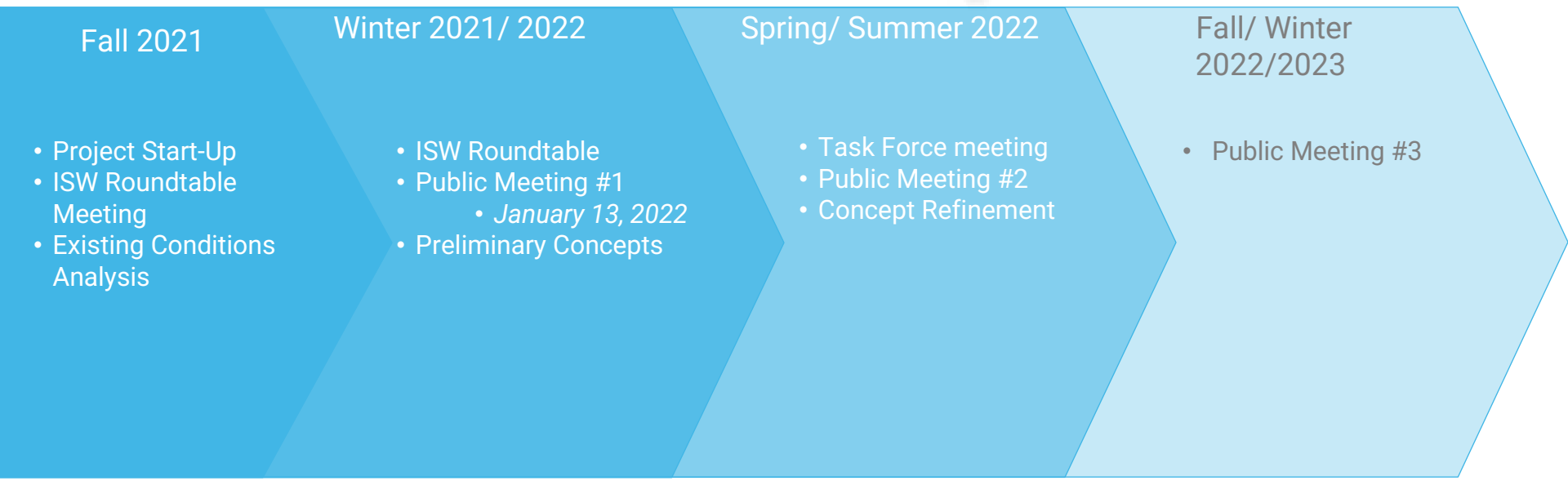

PUBLIC OUTREACH



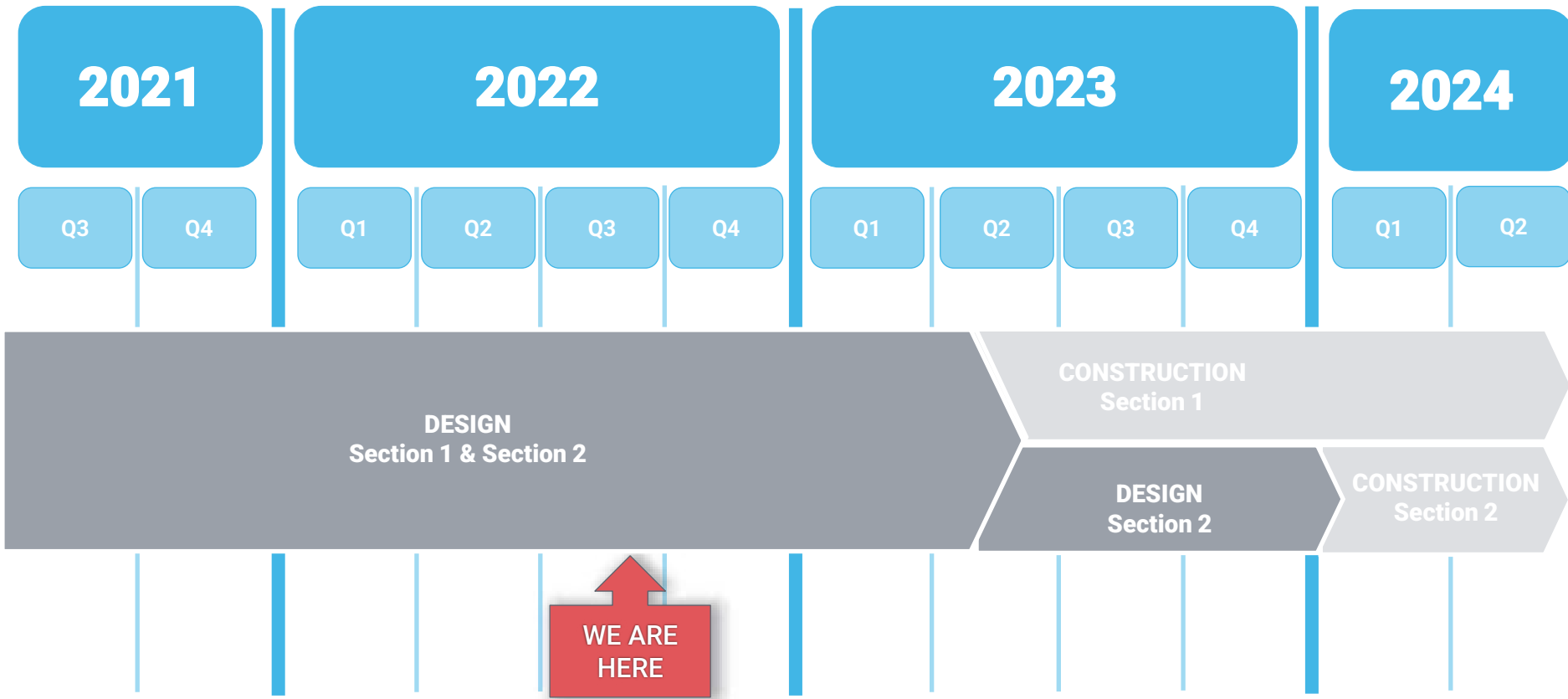

Vision Statement

The ISW Roseland South Michigan Avenue and 111th Street Improvement Project will utilize infrastructure improvements to transform the corridor with engaging pedestrian friendly spaces, gateway features that strengthen community identity, and a consistent visual flow that welcomes visitors and encourages economic investment.



Strengthen Community Identity

Establish community identifiers and visual consistency throughout the corridor to transform the commercial corridor and link the adjacent neighborhoods as one community.



Creating a Destination

Provide wider, welcoming sidewalks, artful seating, and new landscape plantings to support the corridor as a destination and improve overall comfort.

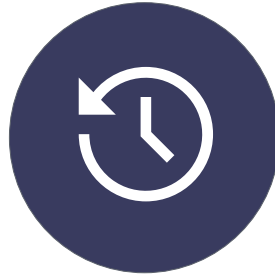

Honor History while Embracing New

Pay tribute to the historical context of the community with traditional elements while incorporating complimentary amenities that bring energy to corridor.



Enhance Safety

Enhance the safety within the streetscape design for all users including pedestrians, mass transit users, bicyclists, and automotive drivers with thoughtful design in all areas of the streetscape.



Design for Accessibility for All

Create accessible routes and crosswalks throughout the corridor and improve areas where existing slopes make access difficult. Provide a variety of seating for all user's comfort.

Narrowing travel lanes can reduce drivers' speed and increase safety for all roadway users and for pedestrians in particular.

- Fewer opportunities for speeding and aggressive driving, thereby decreasing the instances and frequency of crashes.
- Slower speeds mitigate the potential severity of crashes.
- Narrower travel lanes decrease exposure and crossing distance for pedestrians at intersections and midblock crossings, while slower speeds give pedestrians greater opportunity to cross.

Higher speeds are correlated with higher crash severity.

hit by a car driving at...



Safety, Walkability, & Bikability

New curb bump-outs on side streets

- Shorten pedestrian crossing distance
- Enhance visibility between motorists and pedestrians
- Slower turning speeds around corners
- Eliminate illegal parking in the corner clearance zone
- Allow for more sidewalk space at intersections



Example Curb Bump-Outs



Enhanced Visibility at Curb Bump-Out



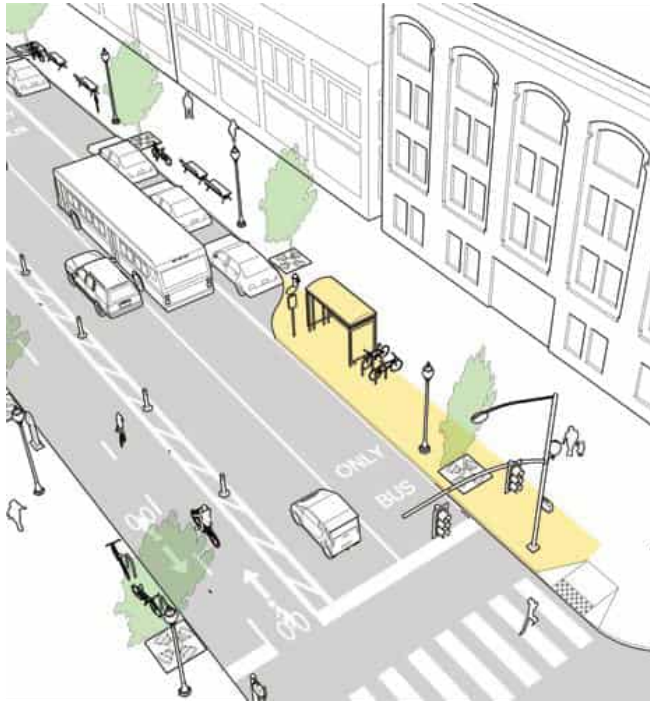

- Provide dedicated space for transit passengers while maintaining clear sidewalks
- Increase transit efficiency by eliminating merge into travel lane from stop
- Reduce “multiple threat” crashes – where a stopped bus obscures the view of moving vehicles next to it
- Allow for other amenities such as site furnishings and wayfinding maps.
- Decrease the crossing distance across the street

The desired length of a bus bulb is the equivalent of two buses for a route with frequent service (e.g. 80 feet for two city buses.)

Source: NACTO





Red stamped crosswalks



Continental crosswalks



STREET LIGHTING

ROADWAY LIGHTING



CHICAGO GATEWAY POLE

PEDESTRIAN/SIDEWALK LIGHTING



SINGLE ACORN



DOUBLE ACORN (EXISTING ON
111TH)

Proposed Improvements

- New wider sidewalks
- Added parkway pavers and street trees
- Added site furniture
- New street and pedestrian lighting
- Maintain on street parking
- Bus Bulbs and Bump outs
- Improved Access to Michigan Ave

EXISTING

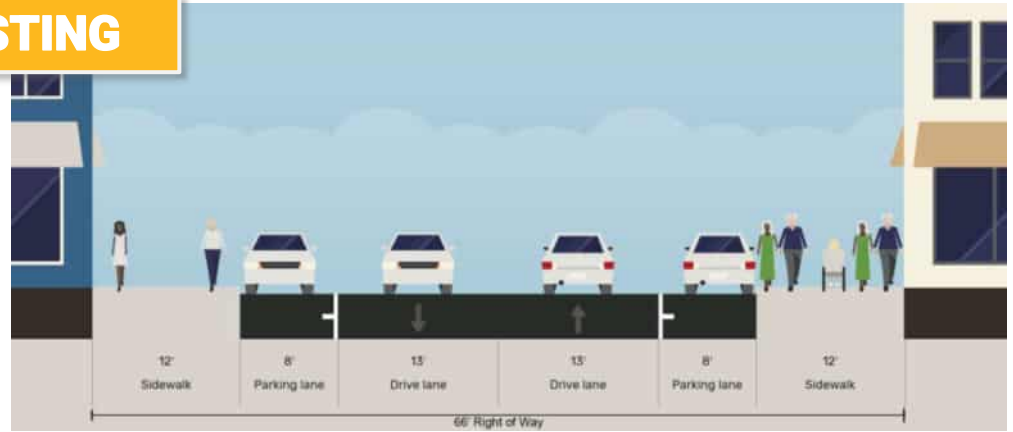

PROPOSED

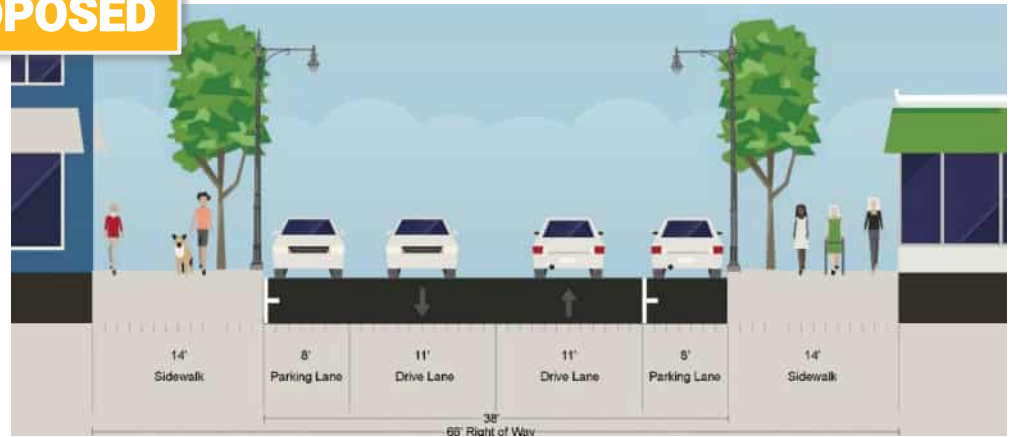

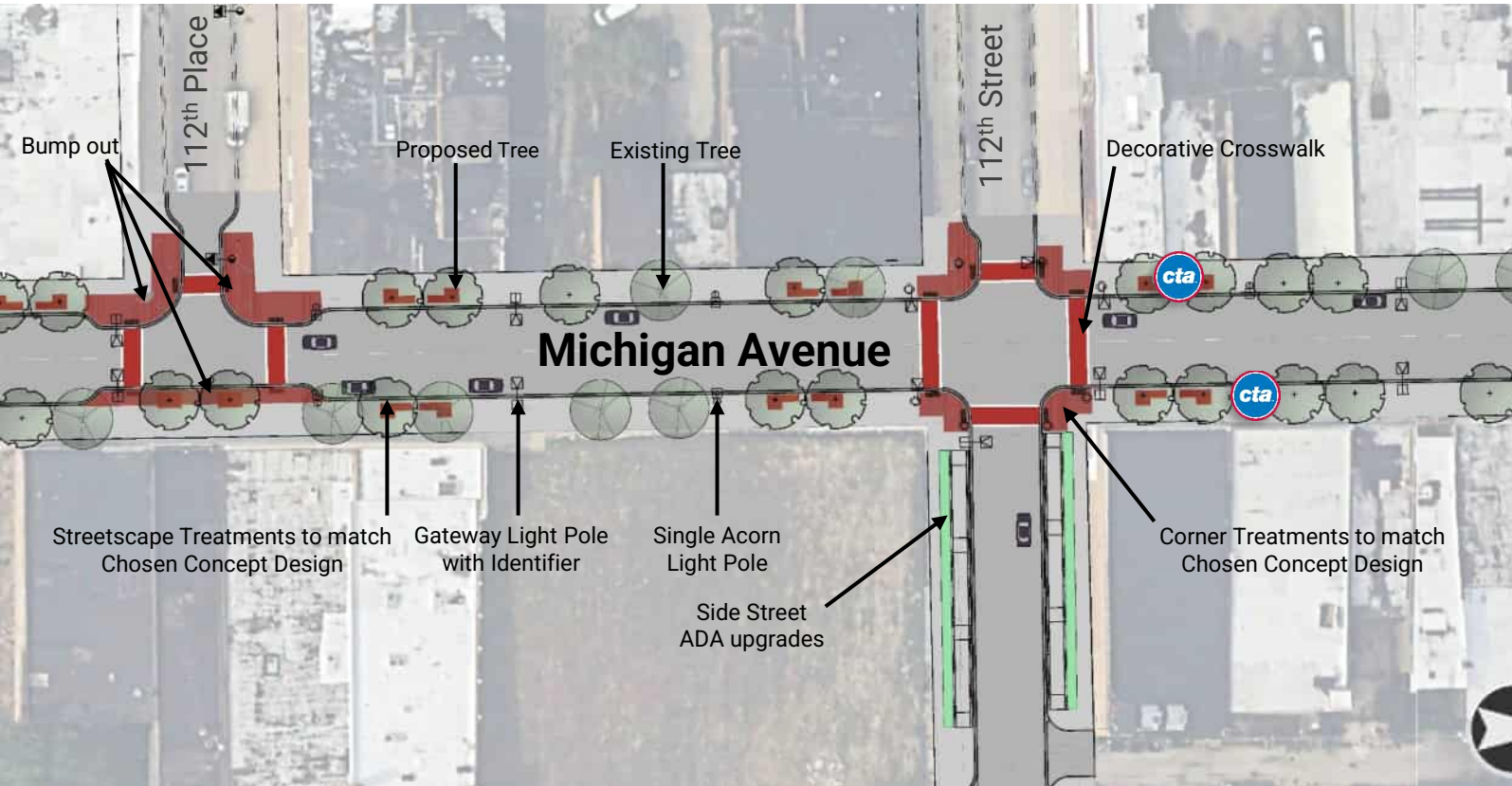

Michigan Ave: 112th to 112th PL.



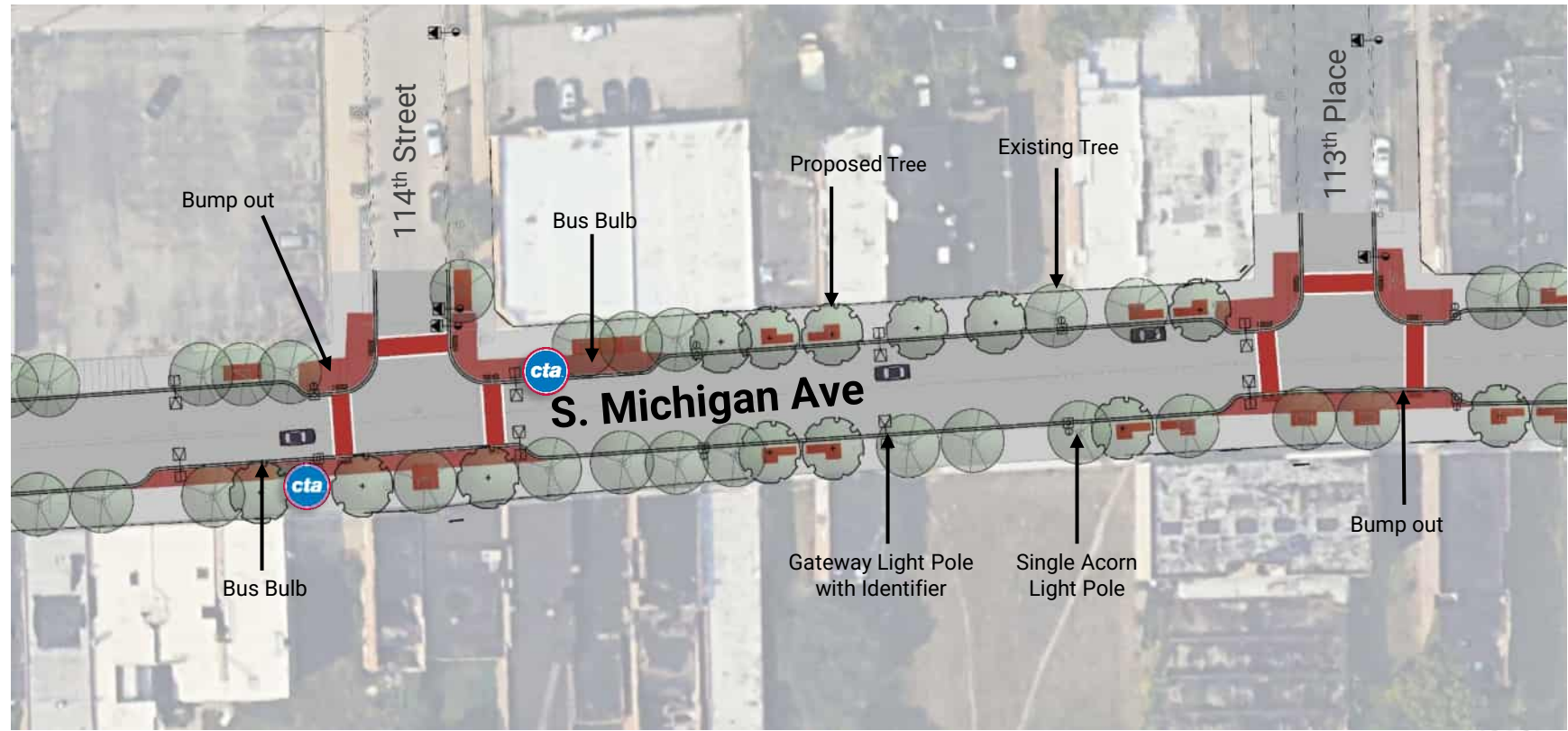

Michigan Ave. 115th Pl. to 113th Pl.



Proposed Improvements

- Cross section will match the existing
- New sidewalks
- Added street trees
- New street and pedestrian lighting
- Maintain on street parking
- Maintain/ upgrade the existing bike facility

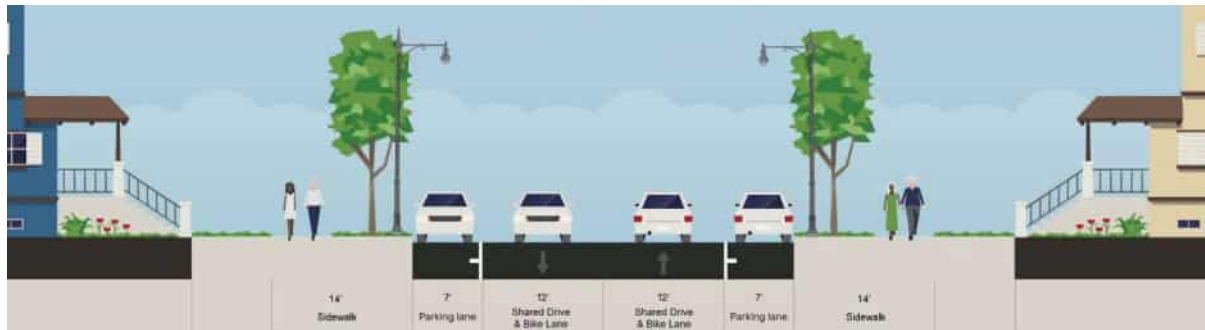

111th: Stewart to MLK



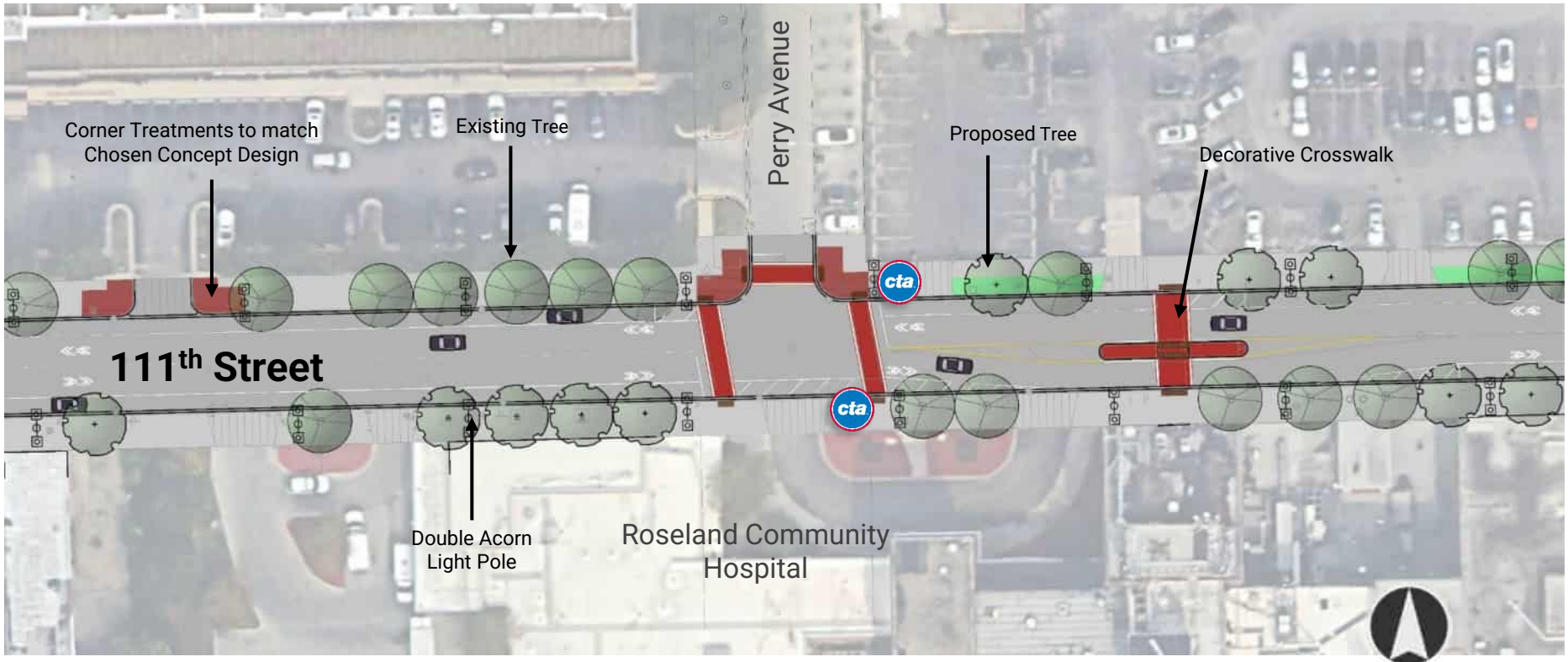

111th: At S. Wabash & Michigan Ave.



Best Fitting Character Winner: Traditional Mix

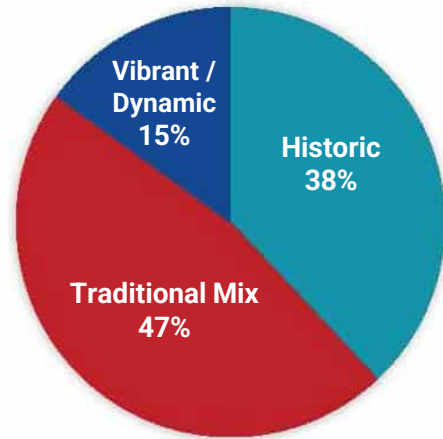

Favorite Seating
Winner: Artful Seating

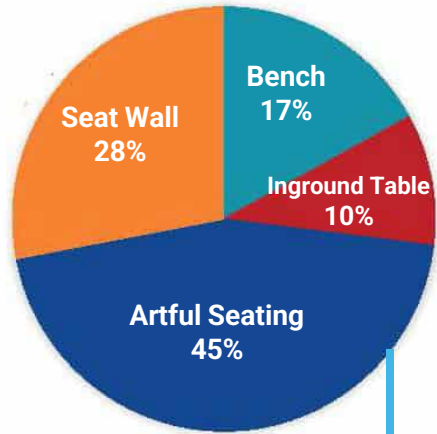

All Seating Options
Winner: Artful Seating & Seat Wall

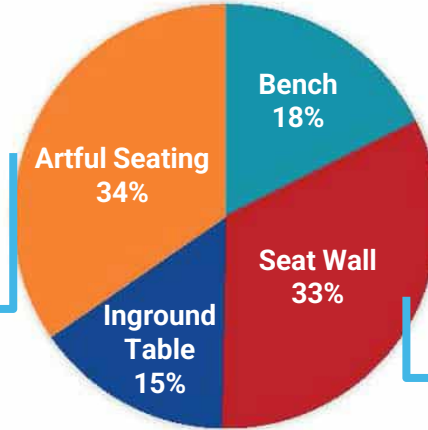

Favorite Landscape Options

Winner: Tree Grates and Seasonal Pots & Plantings with Parkway Fence

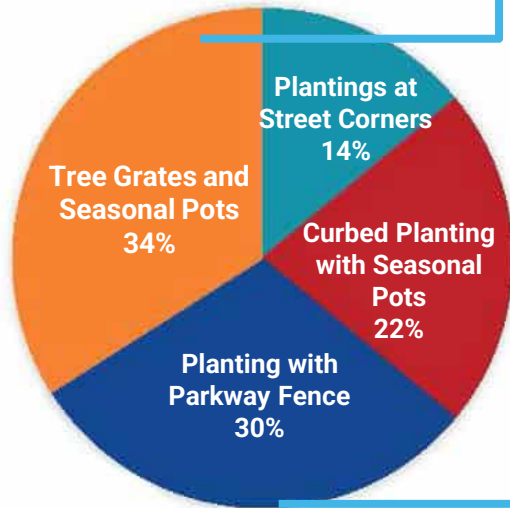

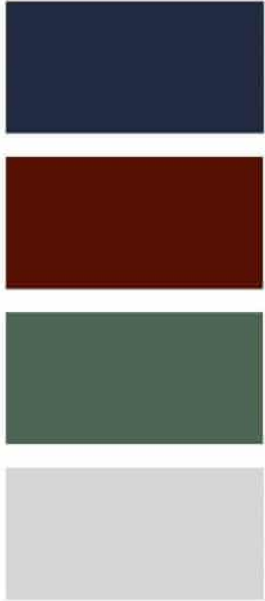

The Avenue

Concept A is inspired by the 1950's and 60's time period when the corridor was known as "The Avenue". The concept incorporates the historic Gatelys People's iconic sign with new site furnishings and gateway features to create a lively setting.

THEME



FURNITURE & LANDSCAPING



Materials:
Metal Bench
Concrete Planter
Clay Pavers



PAVING



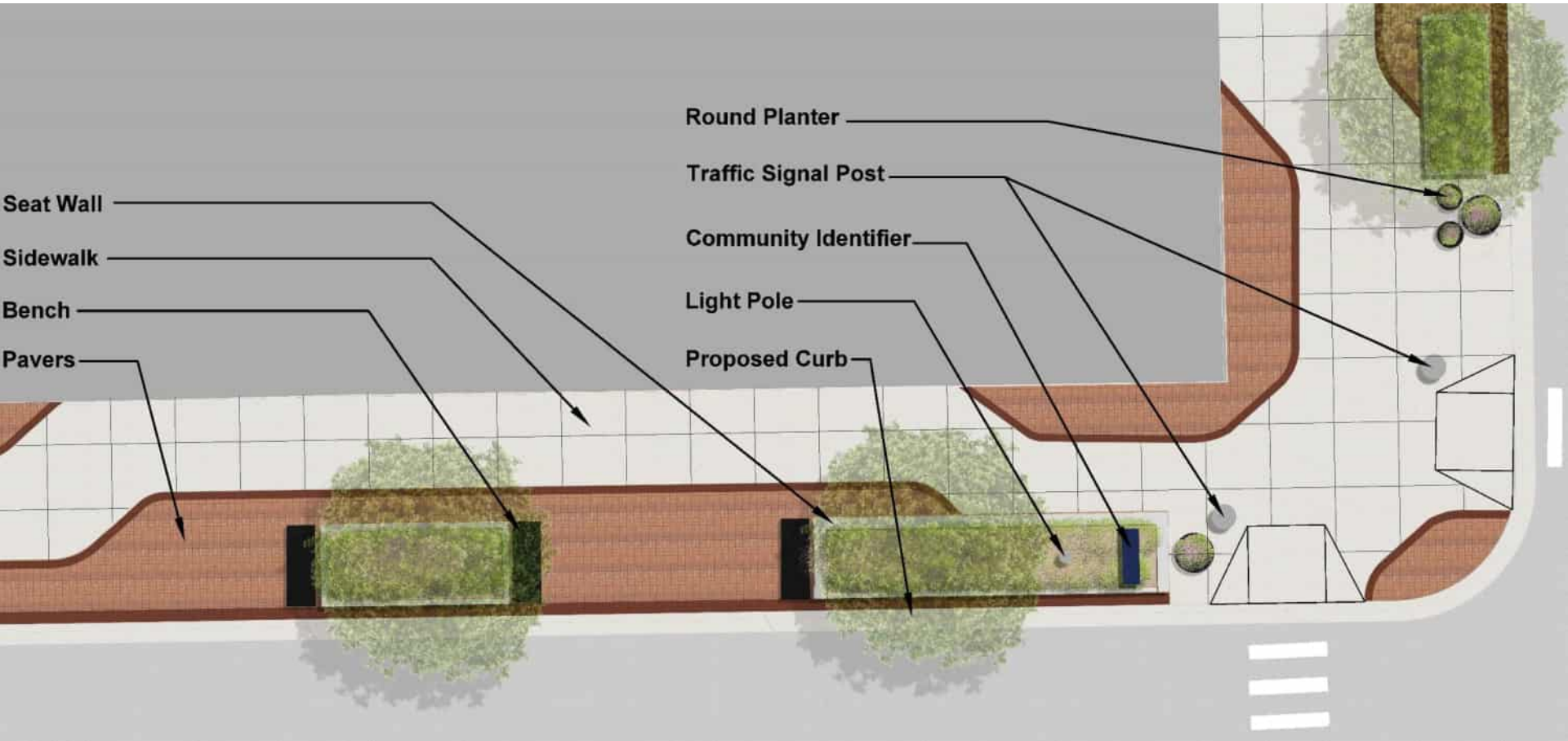





Gateway Identifier



● Gateway Identifier

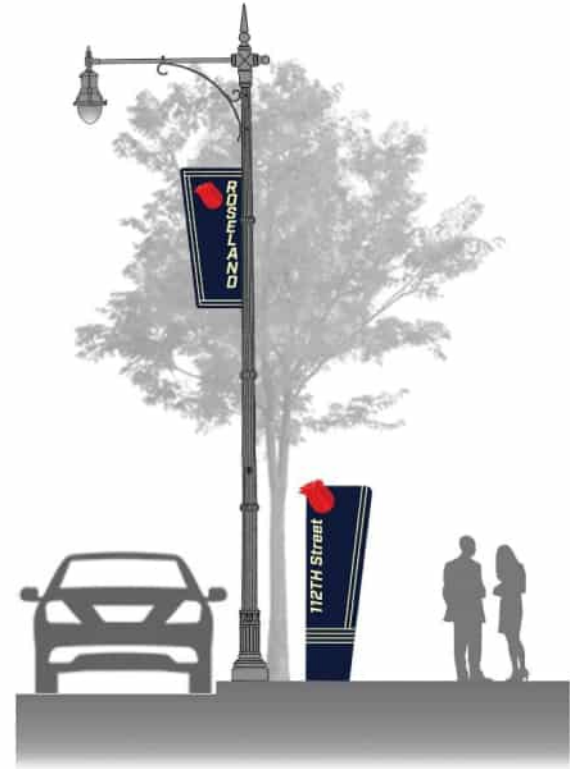

● Light Pole Banner and Street Identifier



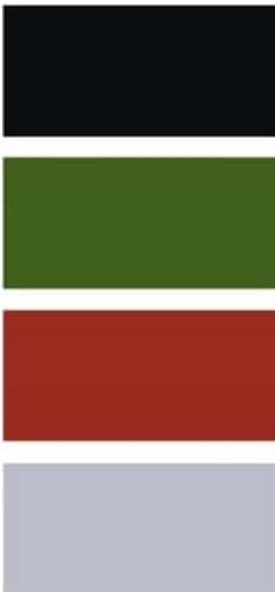

Rose Land

The “Roseland” name was inspired by “the tidy village with its beautiful flowers.” This flower forward concept transforms the rose with a traditional-mix look.

THEME



FURNITURE & LANDSCAPING



Materials:
Metal Bench
Concrete Block Seating
Polyethylene Planter

PAVING



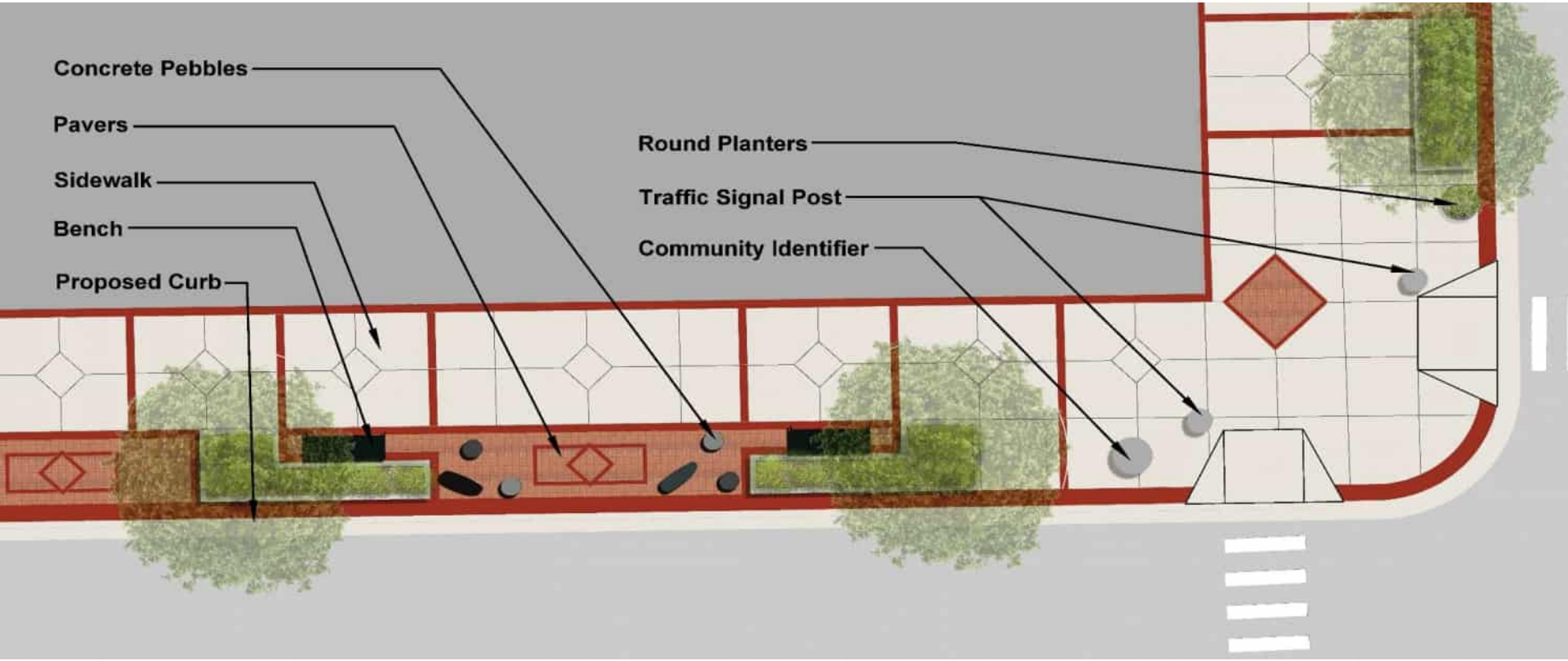







● Gateway Identifier with Catenary Lighting



● Light Pole Banner and Street Identifier Pillar



Internally Lit Community Identifier

What Concept is your favorite?

A: The Avenue



B: Rose Land



What is your favorite seating area?

A:



B:



What is your favorite paving layout?

A:

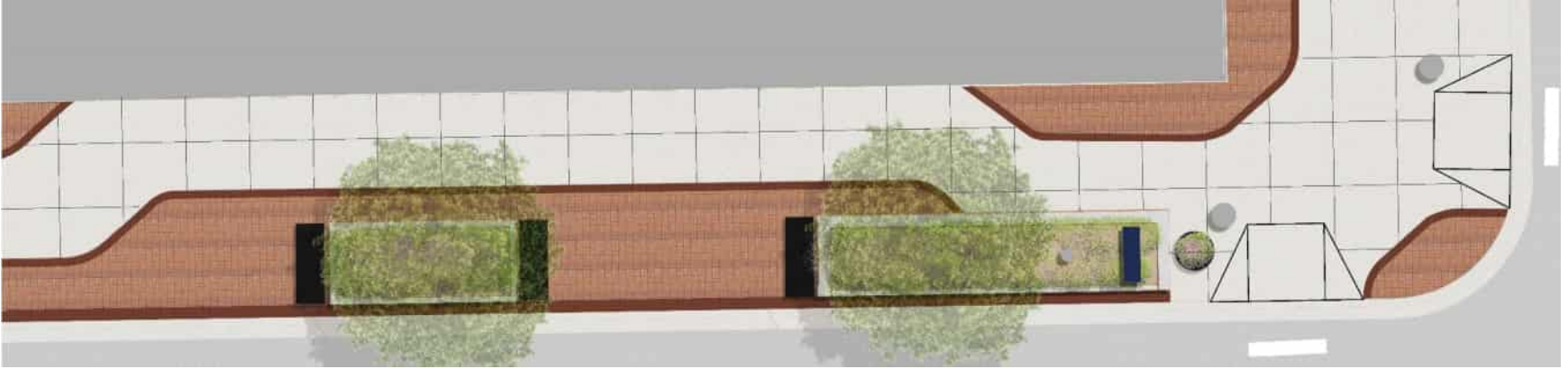

B:

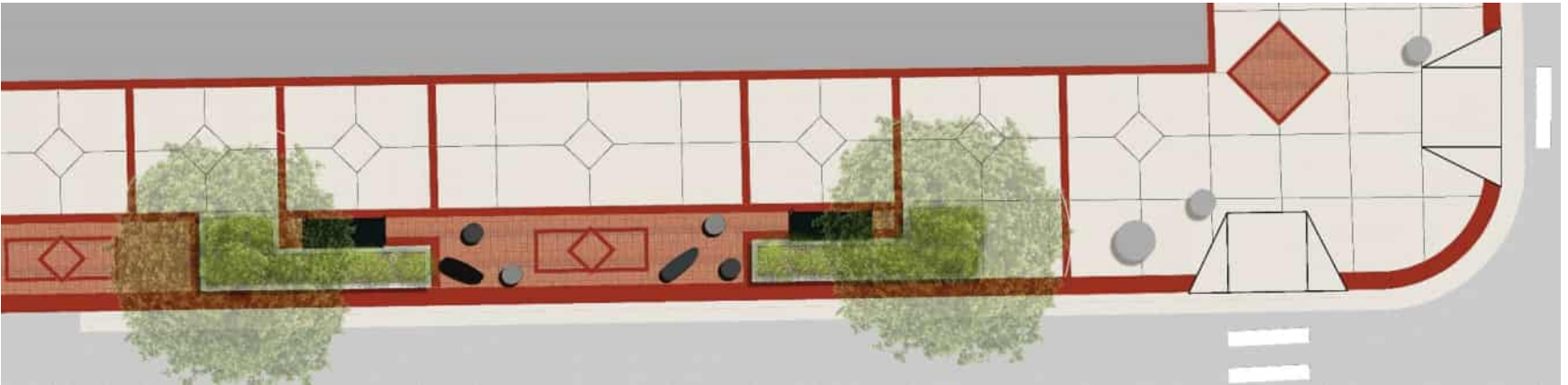

Which Identifier style is your favorite?



A: The Avenue

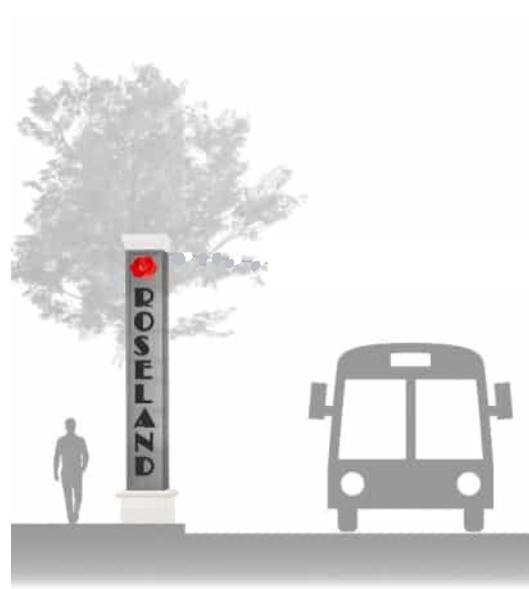

B: Rose Land

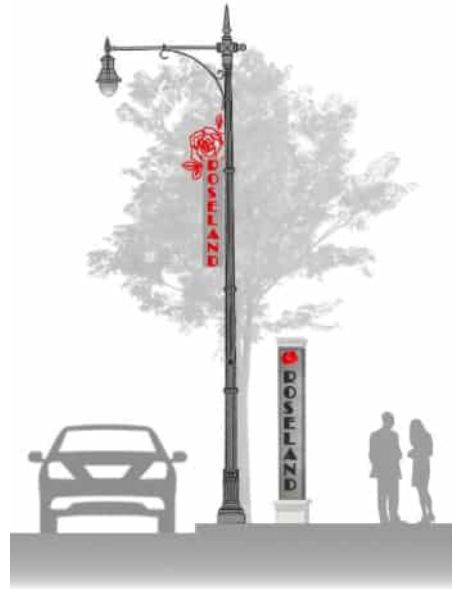

Visit our Website
www.engageiswroseland.com



[Home](#) [Engage](#) [Complete Streets](#)

[Sign in](#) [Register](#)



Welcome to ISW Roseland

South Michigan Avenue from 110th Street to 116th Street & 111th Street from South
Stewart Avenue to South MLK



- 01** Shop Roseland Event – August 27th, 12 PM to 4 PM
Location: 27th East 111th Place
- 02** Public Meeting #3 – Fall/ Winter 2022/ 2023

THANK YOU! THANK YOU! THANK YOU!

We appreciate **YOU** taking the time to join us!

Visit: www.engageiswroseland.com

For upcoming meeting dates and additional information

