

# LAWRENCE AVENUE STREETScape

Section 2: Chicago River to Western Avenue

September 29, 2020

Community Meeting #2



Christopher B. Burke Engineering, Ltd.



## AGENDA

- Introductions and Opening statements
- Presentation of Project Overview and Goals
- Tour of Proposed Project Improvements along the Corridor
- Next Steps
- Questions and Answers

If you have any questions during this presentation, type your question into the Zoom Q&A box then Click Send.  
We will answer your questions at the end.

## DESIGN TEAM:

- Chicago Department of Transportation
- Christopher B Burke Engineering – Civil / Traffic / Lighting Engineering
- Altamanu, Inc – Landscape Architecture & Urban Design
- TranSmart / EJM Engineering, Inc – Engineering Assistance
- O'Brien & Associates – Soil Investigation

## MEETING PANELISTS:

- Alderman Andre Vasquez, Alderman of the 40th Ward
- Geoffrey Cubbage, Director of Policy and Economic Development - 40th Ward
- Rudy Flores, Executive Director - Lincoln Square Ravenswood Chamber of Commerce
- Lubica Benak, Chicago Department of Transportation
- Wade Van Nortwick, Chicago Department of Transportation
- Bryan Luke, Christopher B Burke Engineering
- Josephine Bellalta, Altamanu, Inc

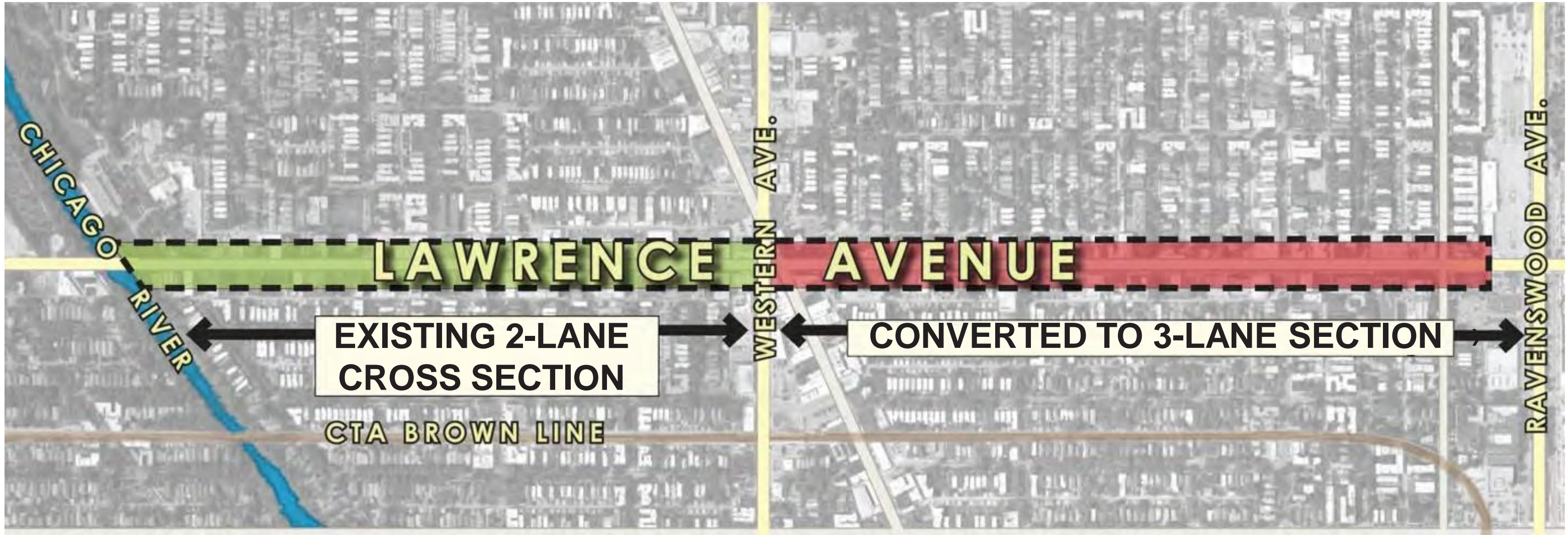

**Streetscape Section 2:  
Chicago River to Western Avenue**

**Streetscape Section 1:  
Western Avenue to Clark Street**

**DESIGN UNDERWAY**

**COMPLETED 2015**



## Existing Conditions

- Various land uses, mixed, commercial, residential
- Narrow sidewalks
- Non-compliant ADA ramps
- Faded pavement markings
- Poor drainage
- Crumbling asphalt
- Poor lighting with overhead cable
- Void of Trees and Landscape
- Void of cohesive livable design
- Trolley Tracks
- Utility conflicts

## Project Goals

- Improve safety for all users
- Upgrade aging infrastructure
- Create a livable street and increase walkability
- Support economic development

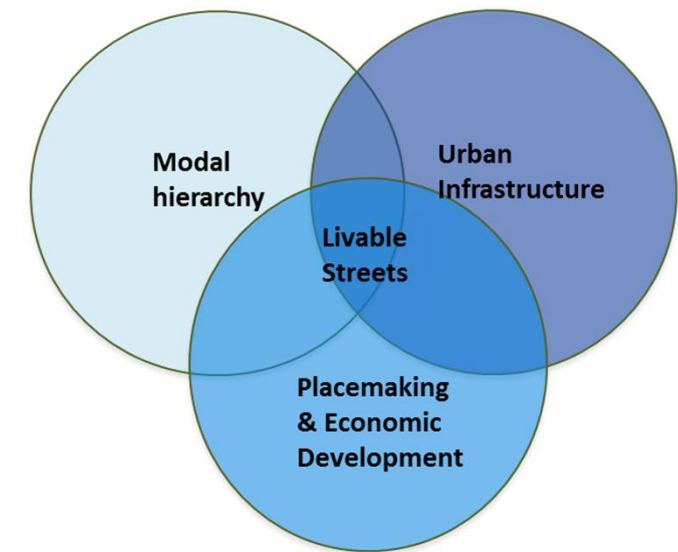



- Wider Sidewalks
- New curb and gutter
- New pavement markings
- New ADA ramps and crosswalks
- New trees

- New traffic signs
- Parkway pavers
- Community Identifiers, light pole and gateway
- Street and Pedestrian lighting
- Full Street Resurfacing

- Restripe designated bike lane
- Bump outs to create shorter pedestrian crossing distances
- Decrease lane widths to reduce speed
- Reversal of Francisco
- Pedestrian refuge island at Francisco
- Contraflow bike lanes on Francisco

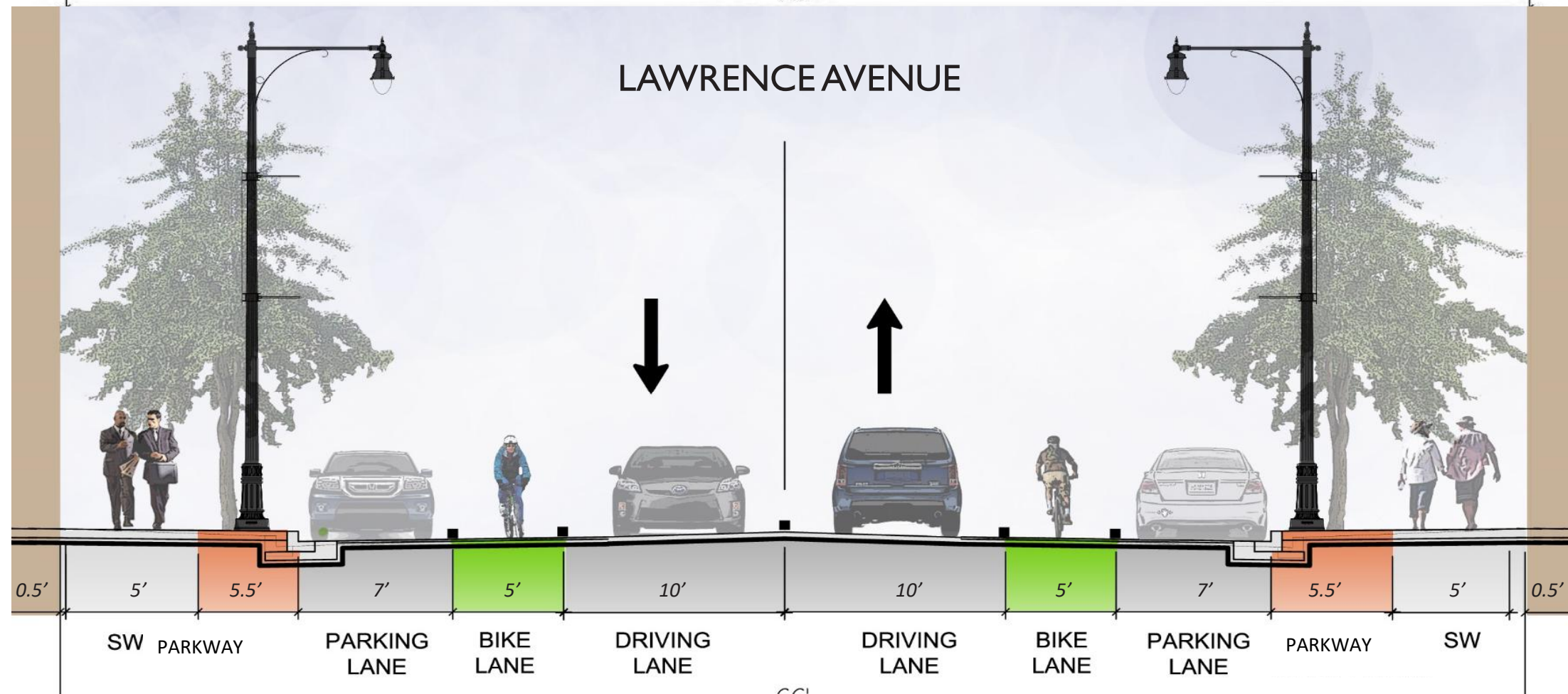
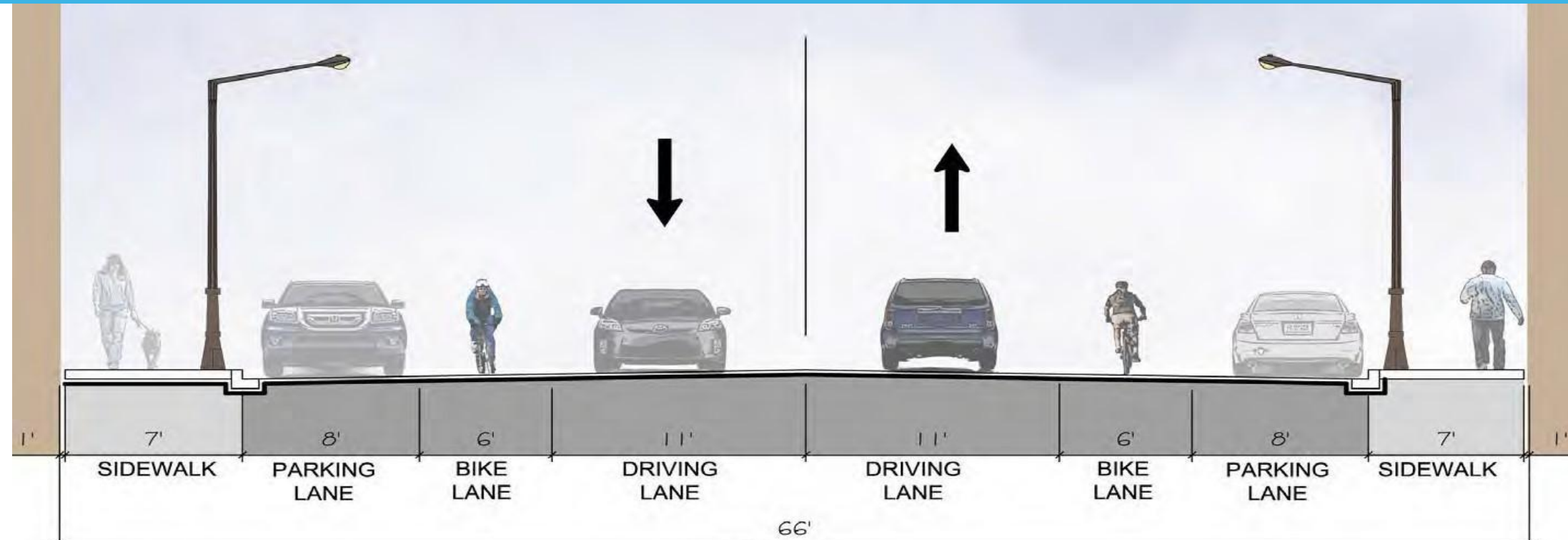

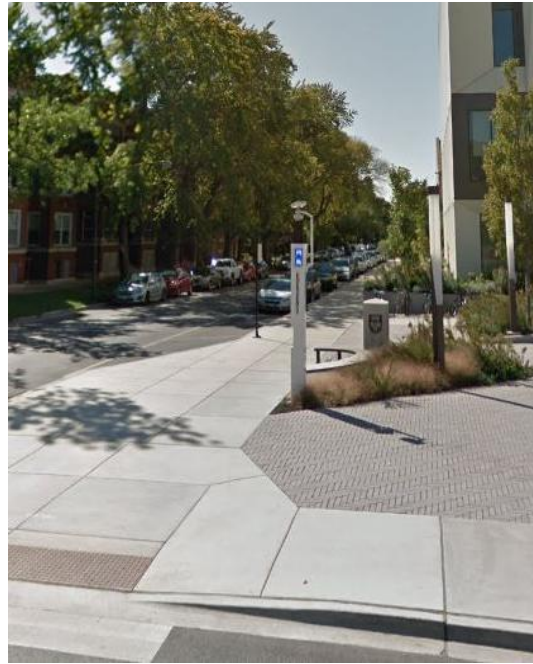

- ADA Compliant crossings/ramps
- Stamped red brick decorative crosswalks

- Shorter pedestrian crossing distances
- Larger buffer zone for pedestrians

↕ Proposed Bump-out Locations



## NEW STREET TREES



## NEW PAVEMENT PATTERNS



## NEW FLOWERPOTS

Dura Art Stone – Savannah Planter

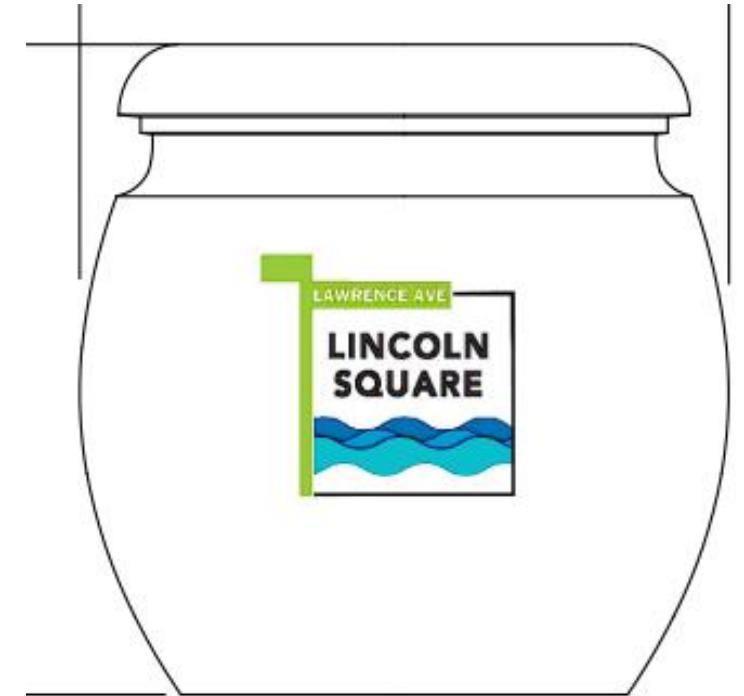

# PROPOSED WIDER SIDEWALKS

BIKE RACK



BACKLESS BENCH



TRASH RECEPTACLE



BACKED BENCH

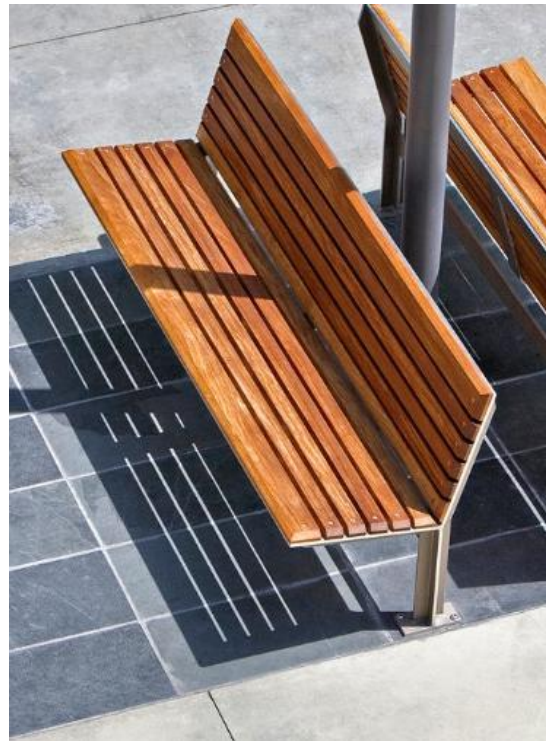

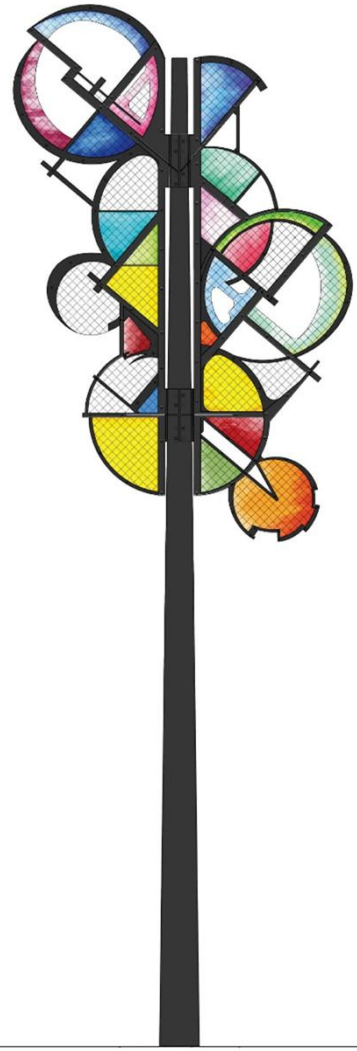

GATEWAY

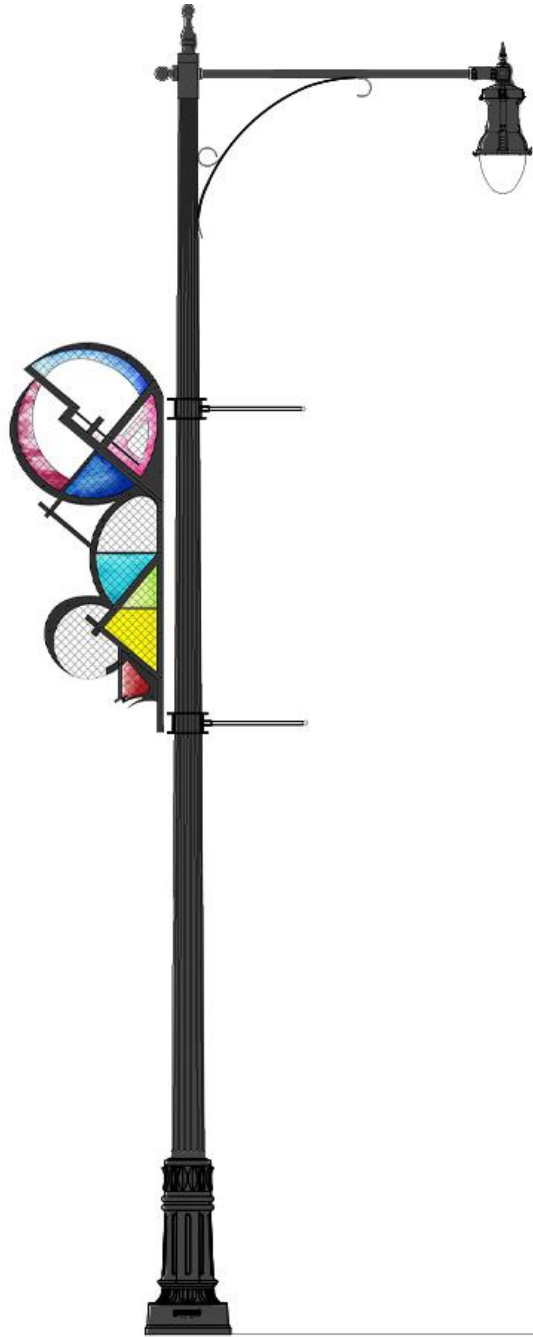

LIGHTPOLE  
TYPE 1

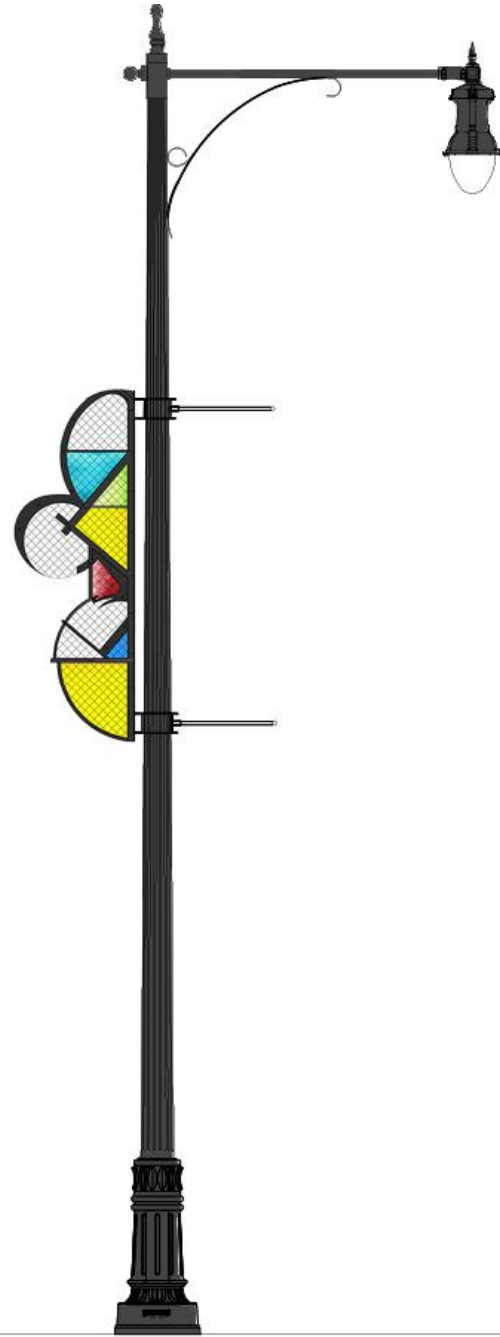

LIGHTPOLE  
TYPE 2



LIGHTPOLE  
TYPE 3

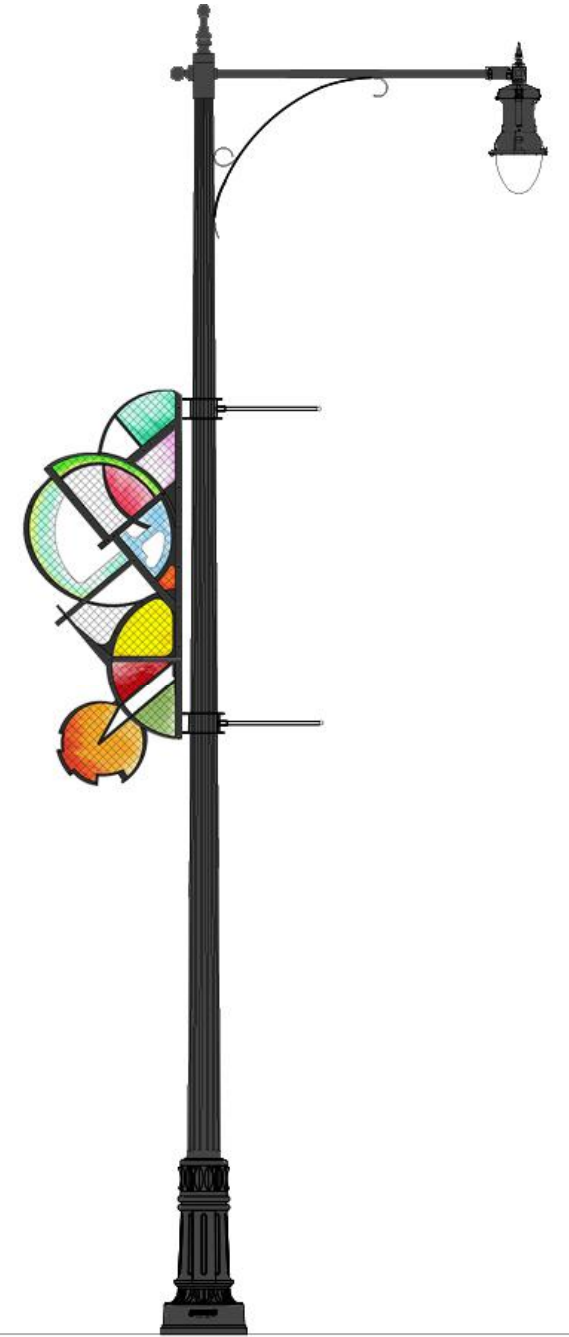

LIGHTPOLE  
TYPE 4

- Two Gateways located at Northeast corner of Washtenaw and Southeast corner of Artesian.
- Light Pole Identifiers: on Gateway light poles 26

## EXISTING IMPROVEMENTS EAST OF W LAWRENCE AVE (CLARK TO WESTERN)



ROAD DIET AND DEDICATED BIKE LANES



WIDER SIDEWALKS & DOUBLE ACORN LIGHTS



IDENTIFIERS

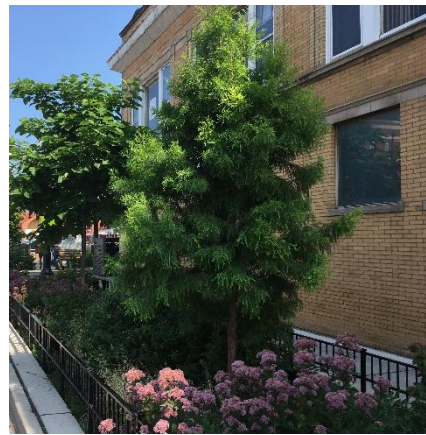

PLANTERS & TREES



TRASH CANS



BENCHES



CHAIRS



PAVER PATTERNS

## PROPOSED IMPROVEMENTS WEST OF W LAWRENCE AVE (WESTERN TO FRANCISCO)



ROAD DIET & PROTECTED BIKE LANES



WIDER SIDEWALKS



BIKE RACK



COMMUNITY IDENTIFIERS & GATEWAY LIGHTS

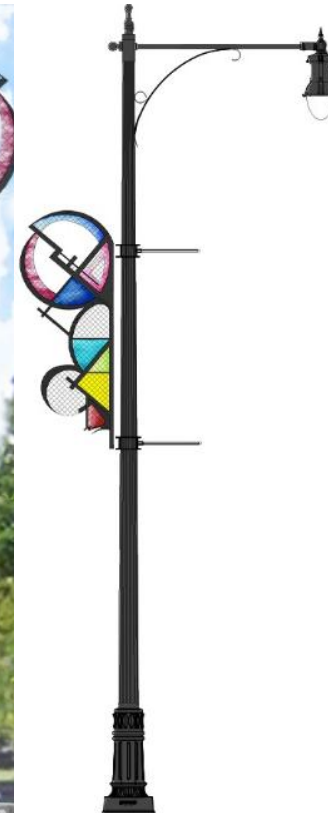

TREES



TRASH CANS

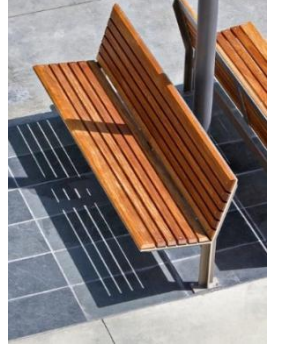

BACKED BENCH



BACKLESS BENCH



FLOWERPOTS



PAVEMENT PATTERNS

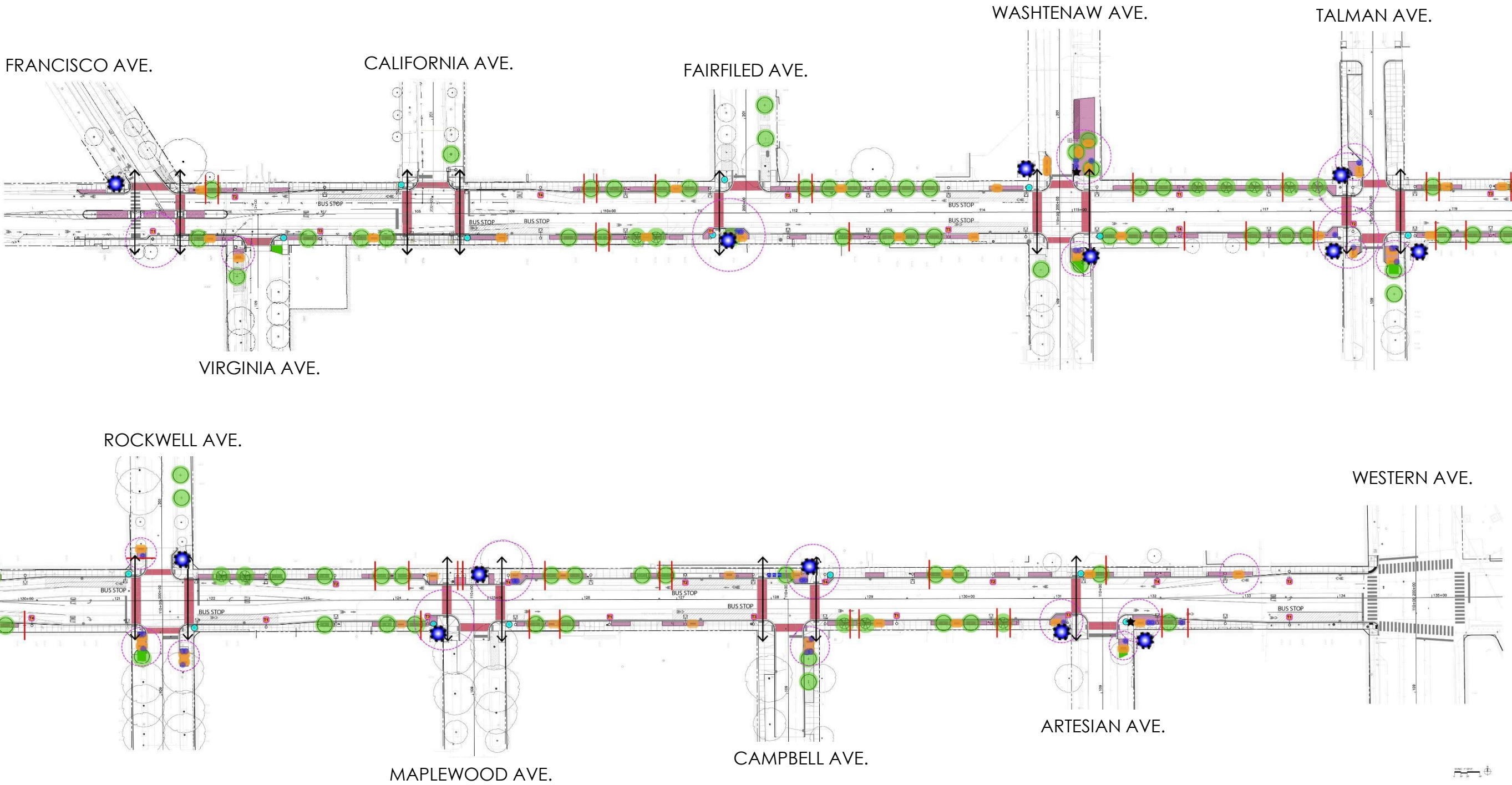

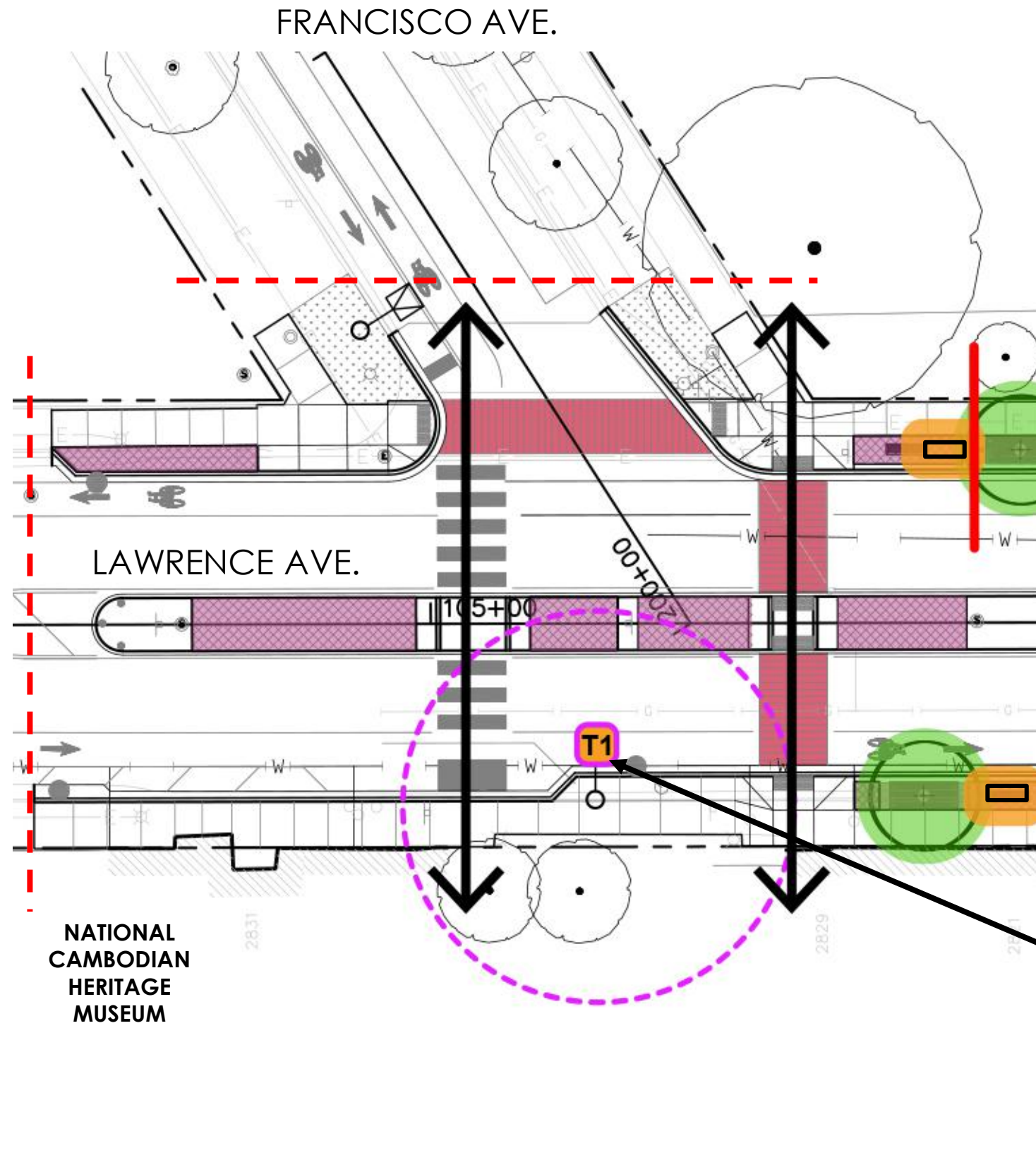

KEY:

- TREE
- PRECAST PLANTER
- BENCH
- TRASH RECEPTACLE
- PLANTING BED
- BIKE RACK
- PAVERS
- STAMPED THERMOPLASTIC
- LIGHTPOLE ID
- BUMP-OUT/PLAZA
- CROSS WALK
- ★ GATEWAY

CONSTRUCTION LIMITS



SCALE: 1"=20'-0"

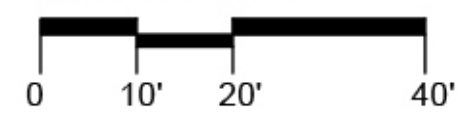



PROPOSED W LAWRENCE AVE AND N FRANCISCO AVE LOOKING NORTHWEST



PROPOSED N FRANCISCO AVE LOOKING NORTH



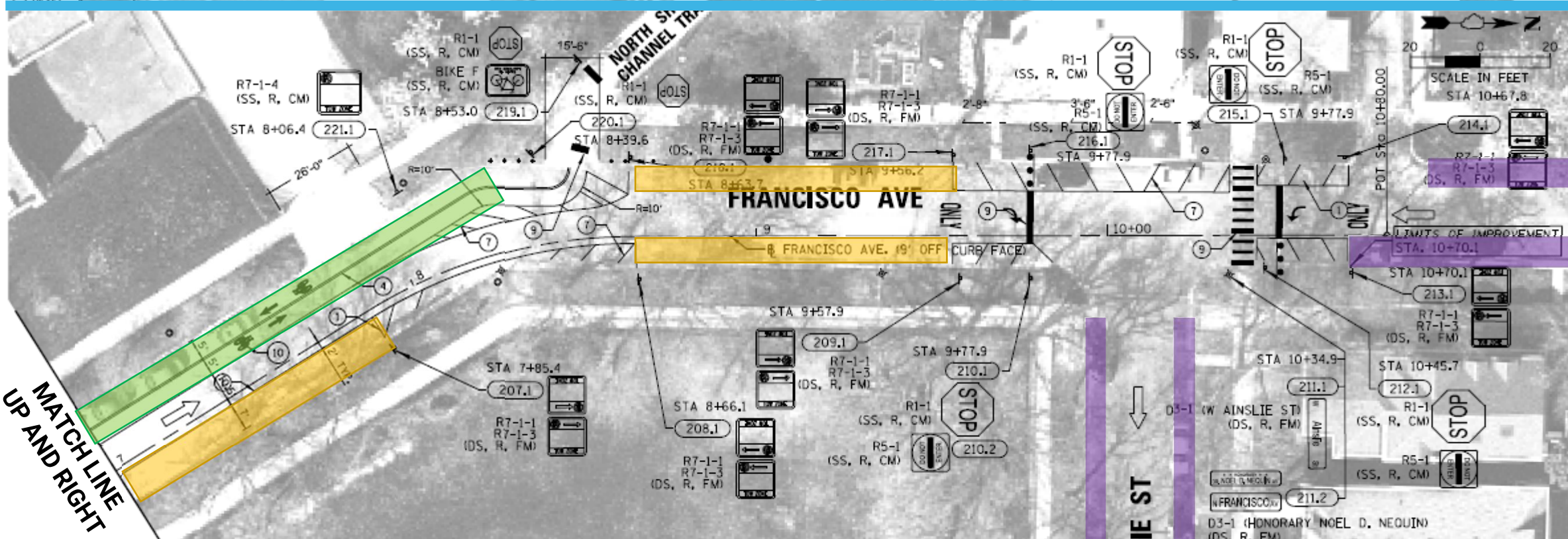
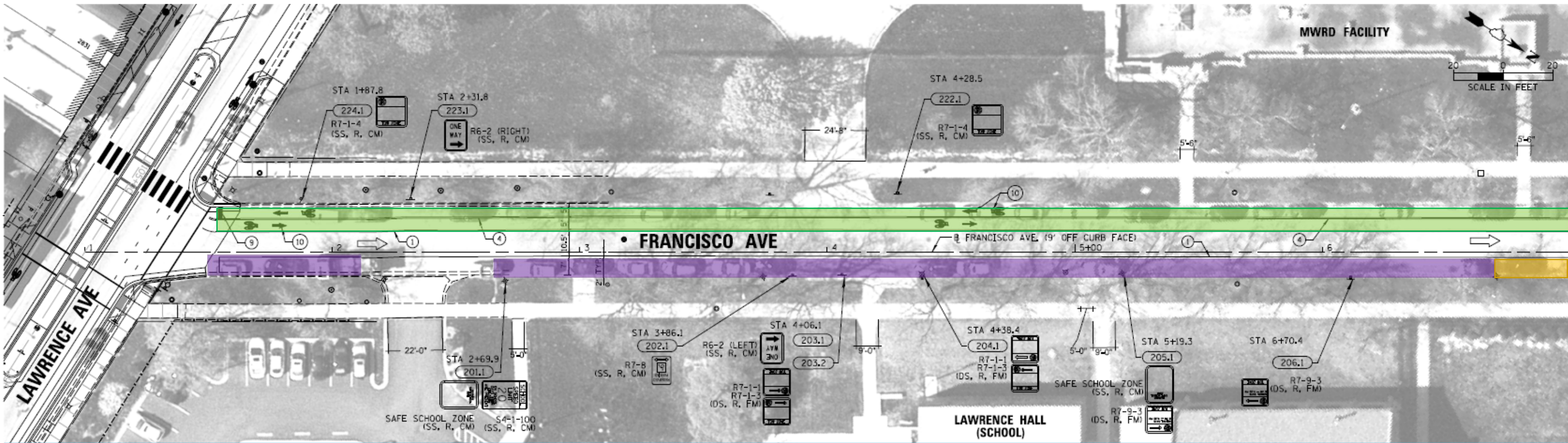

- ### LEGEND
- PROPOSED BIKE LANES
  - EXISTING PARKING TO REMAIN
  - NEW PARKING

## EXISTING



## PROPOSED



# PROPOSED N FRANCISCO AVE TRAFFIC FLOW

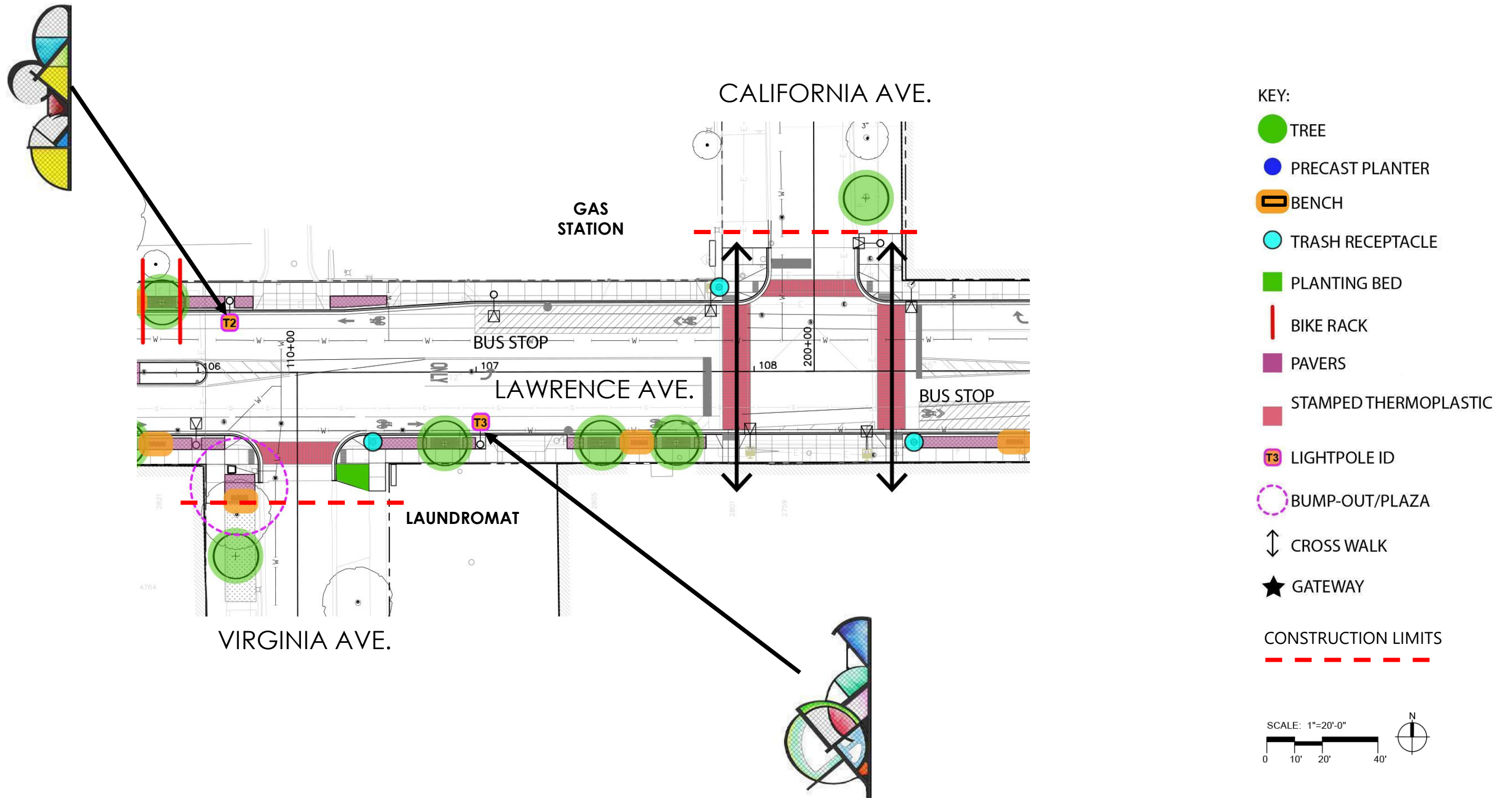

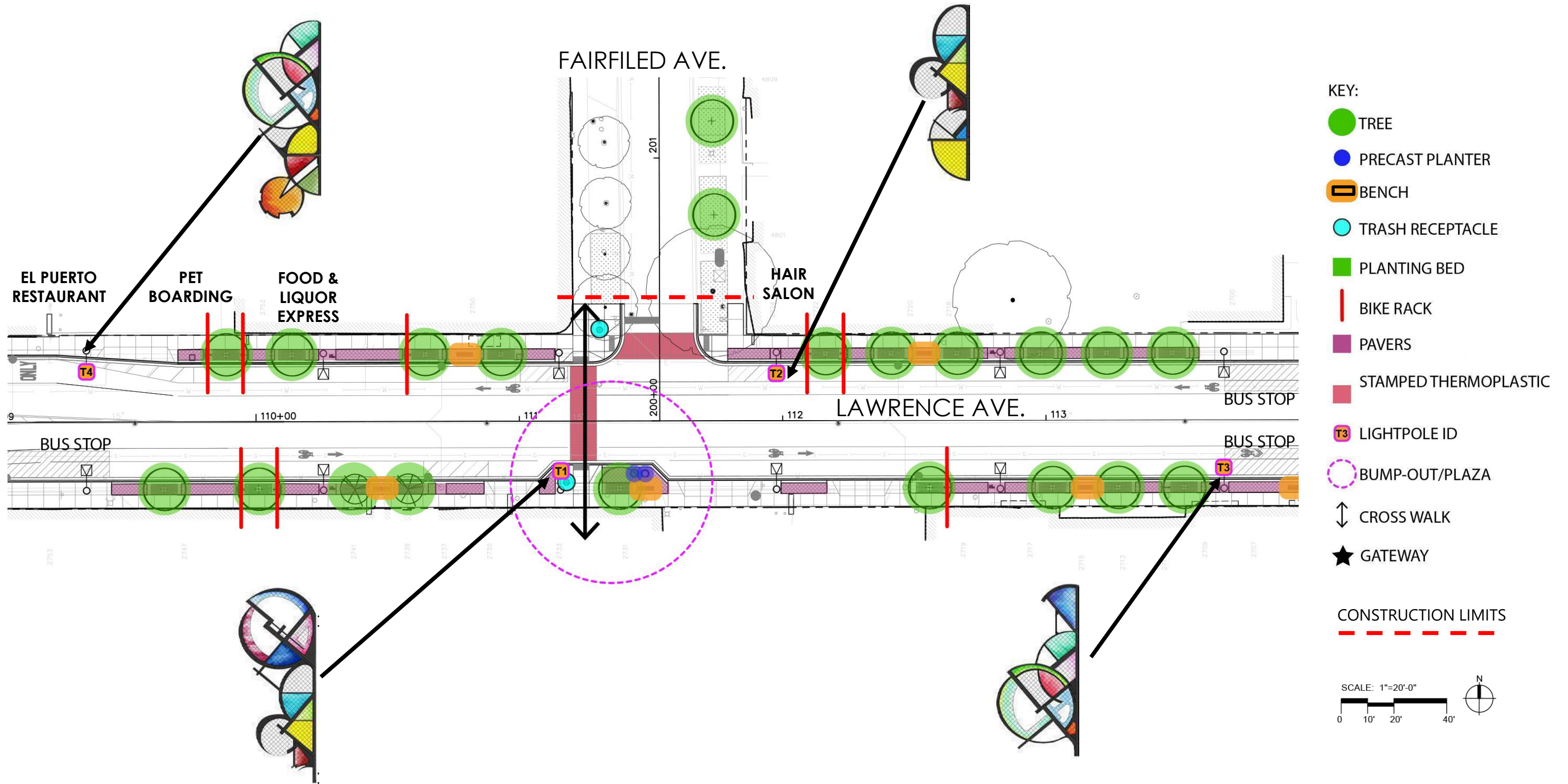

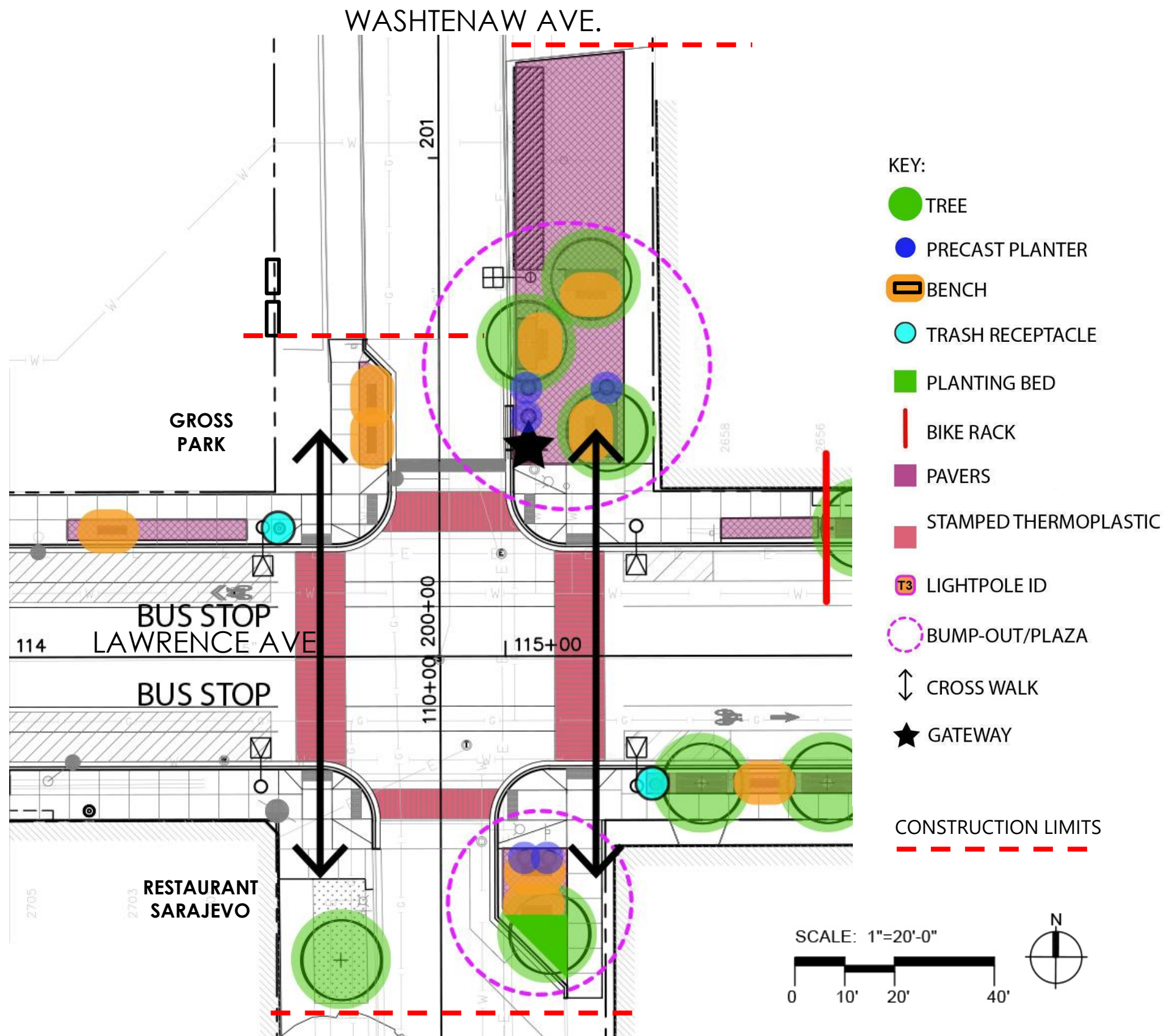



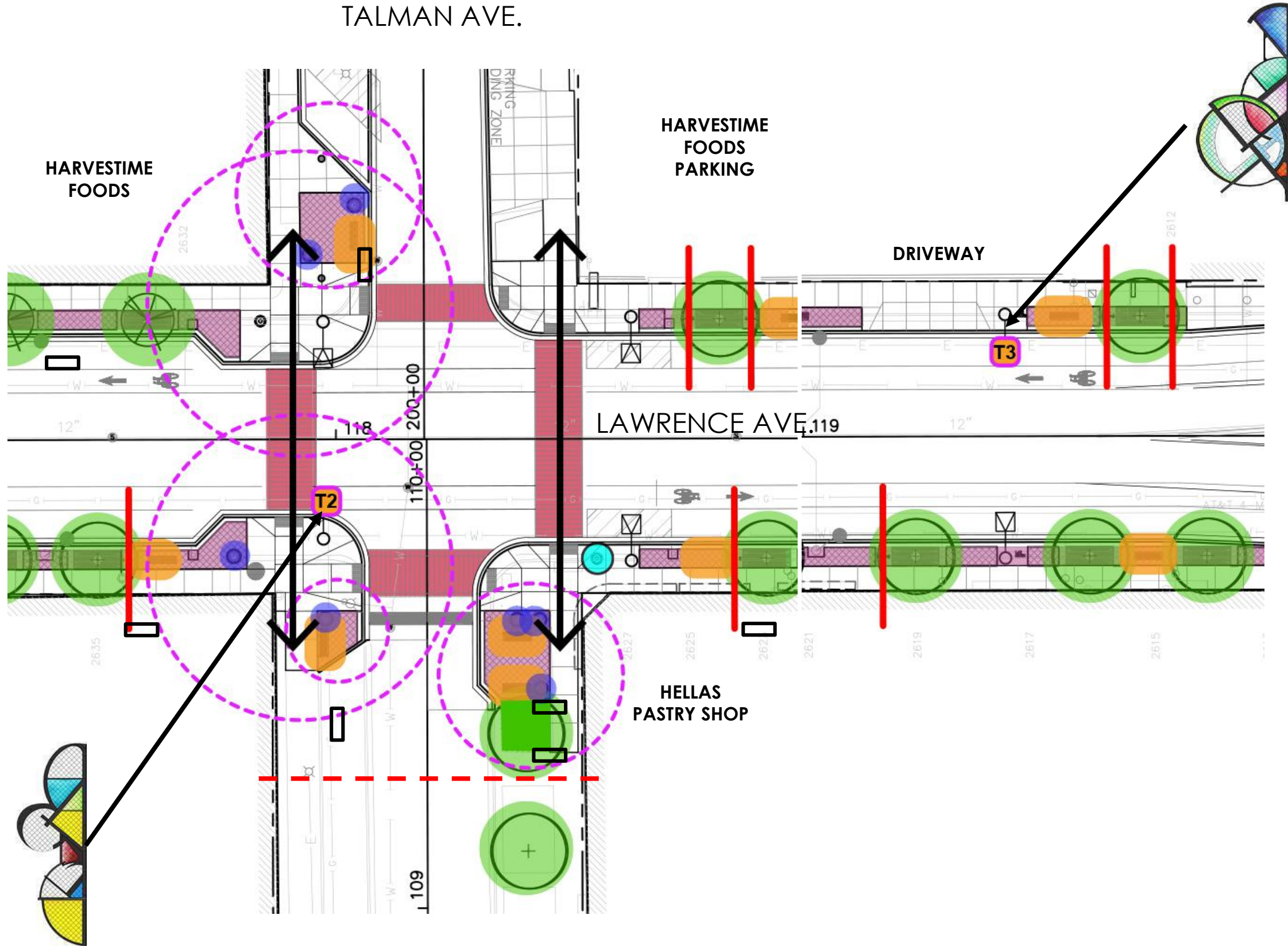

- KEY:
- TREE
  - PRECAST PLANTER
  - BENCH
  - TRASH RECEPTACLE
  - PLANTING BED
  - BIKE RACK
  - PAVERS
  - STAMPED THERMOPLASTIC
  - T3 LIGHTPOLE ID
  - BUMP-OUT/PLAZA
  - CROSS WALK
  - ★ GATEWAY
- CONSTRUCTION LIMITS
- 

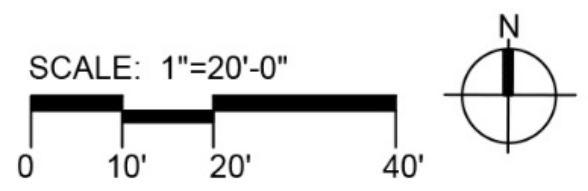



PROPOSED W LAWRENCE AVE AND N TALMAN AVE LOOKING SOUTHEAST



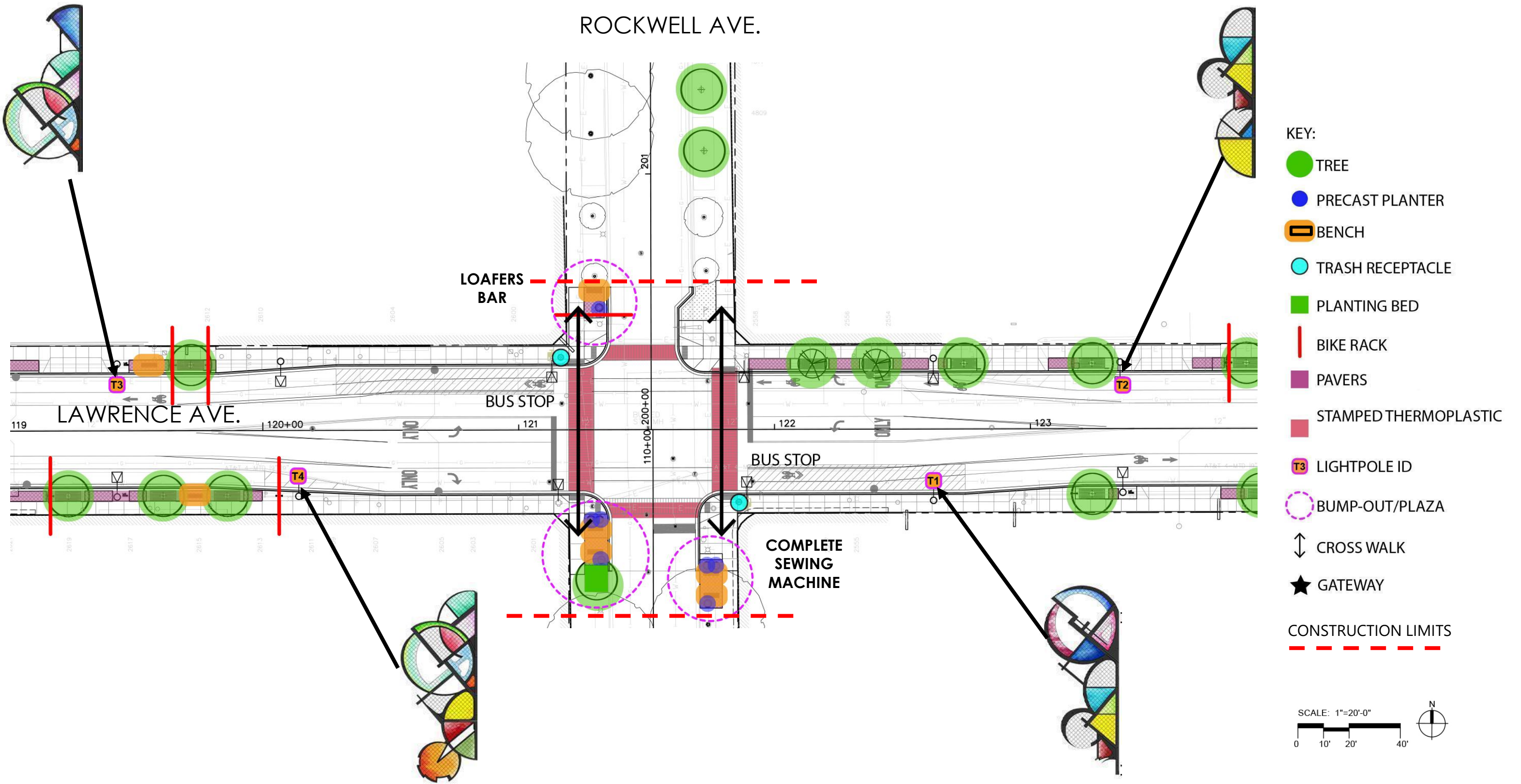

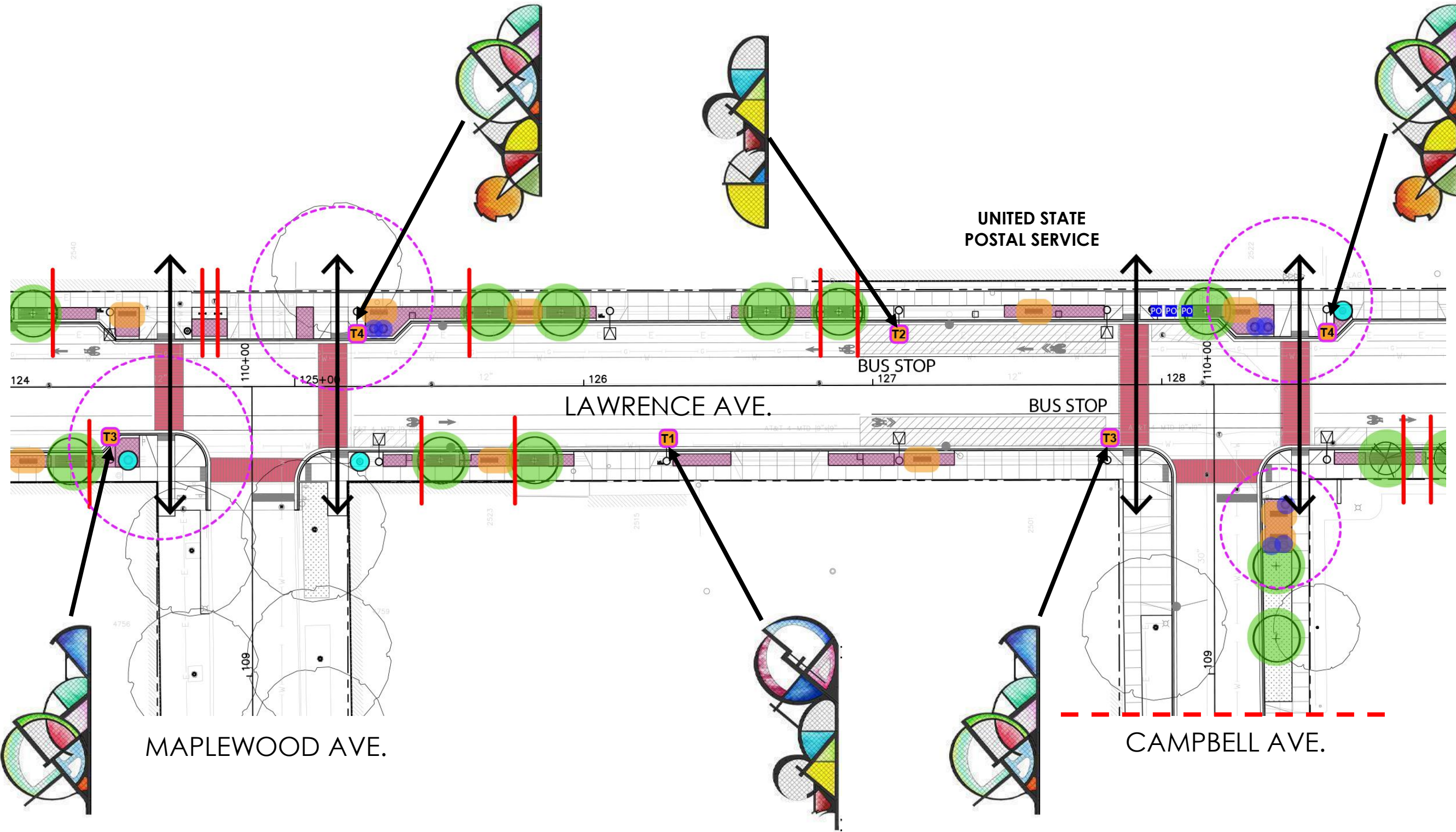

- KEY:
- TREE
  - PRECAST PLANTER
  - ▭ BENCH
  - TRASH RECEPTACLE
  - ▭ PLANTING BED
  - | BIKE RACK
  - ▭ PAVERS
  - ▭ STAMPED THERMOPLASTIC
  - T LIGHTPOLE ID
  - BUMP-OUT/PLAZA
  - ↕ CROSS WALK
  - ★ GATEWAY

CONSTRUCTION LIMITS  
- - - - -

SCALE: 1"=20'-0"



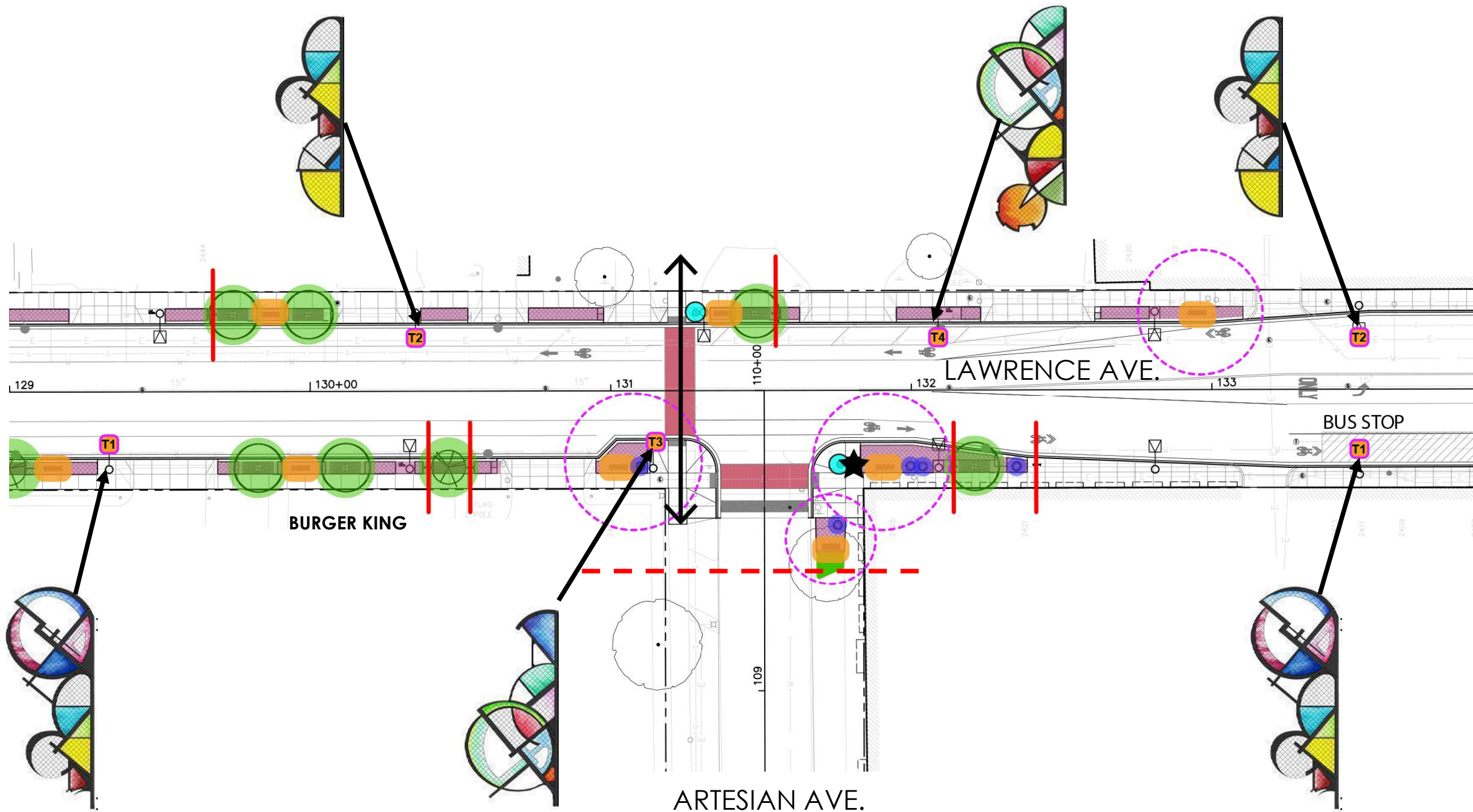

- KEY:**
- TREE
  - PRECAST PLANTER
  - BENCH
  - TRASH RECEPTACLE
  - PLANTING BED
  - BIKE RACK
  - PAVERS
  - STAMPED THERMOPLASTIC
  - T3 LIGHTPOLE ID
  - BUMP-OUT/PLAZA
  - CROSS WALK
  - ★ GATEWAY

CONSTRUCTION LIMITS

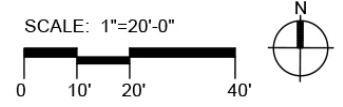

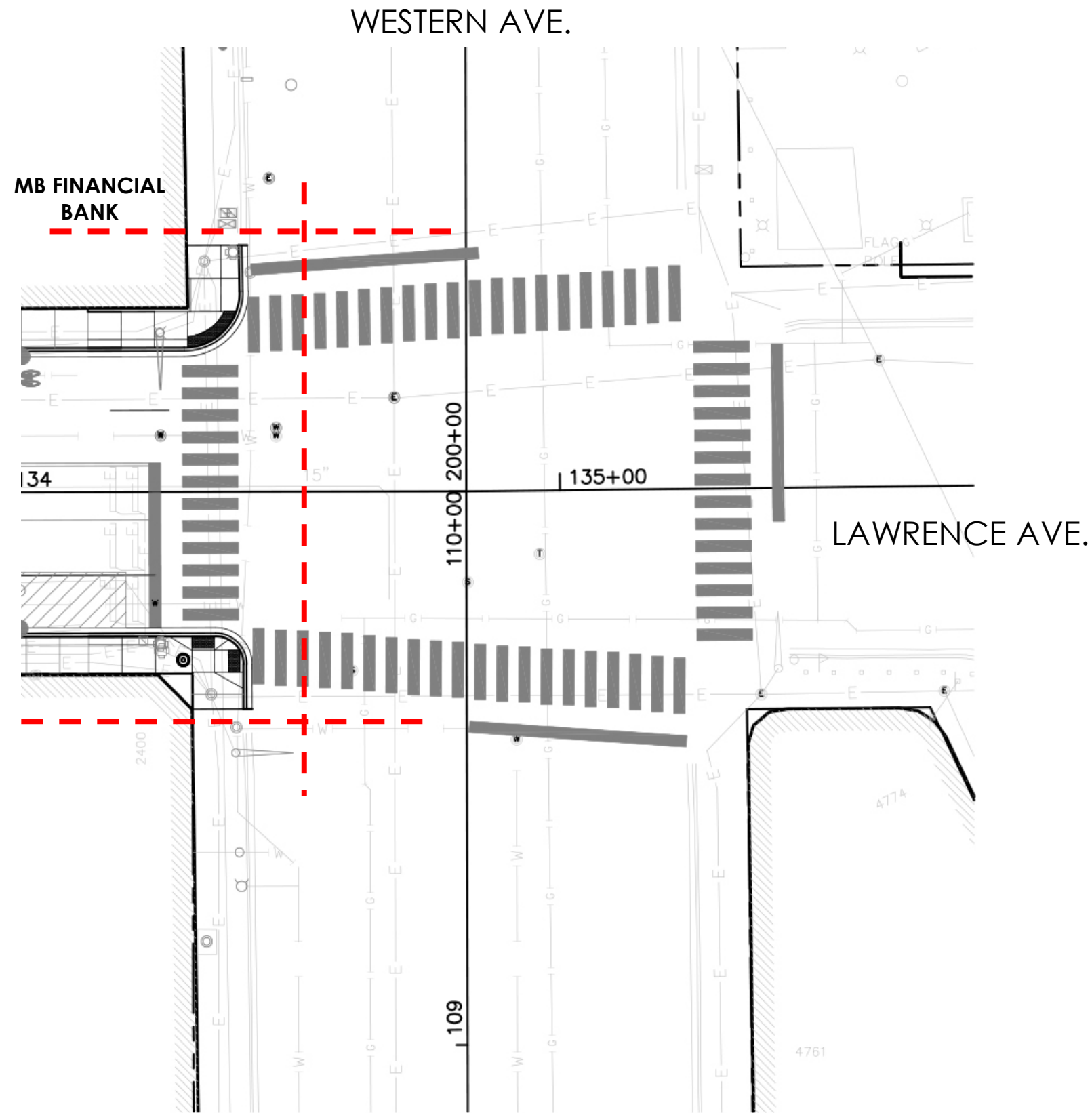

- KEY:
- TREE
  - PRECAST PLANTER
  - BENCH
  - TRASH RECEPTACLE
  - PLANTING BED
  - BIKE RACK
  - PAVERS
  - STAMPED THERMOPLASTIC
  - T3 LIGHTPOLE ID
  - BUMP-OUT/PLAZA
  - ↑  
↓ CROSS WALK
  - ★ GATEWAY
  - CONSTRUCTION LIMITS

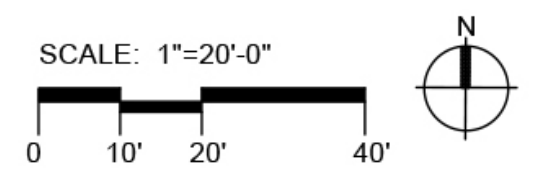

## Next Steps:

- Fall 2020 - Finish Construction Documents
  - Winter 2020 – Advertise for bids; Award construction contract
  - Spring/Early Summer 2021 – Start Construction
  - Fall 2022 – Complete Construction
- 
- Construction flyer notice
  - Construction field office located on site
  - Weekly construction meetings open to the public
  - Access to buildings maintained throughout construction
  - Direct coordination with individual businesses and homeowners as required
- 
- Expect traffic delays
  - Bus stops will be maintained, but may be temporarily relocated
  - Signed bicycle detour/alternate route will be provided



Before

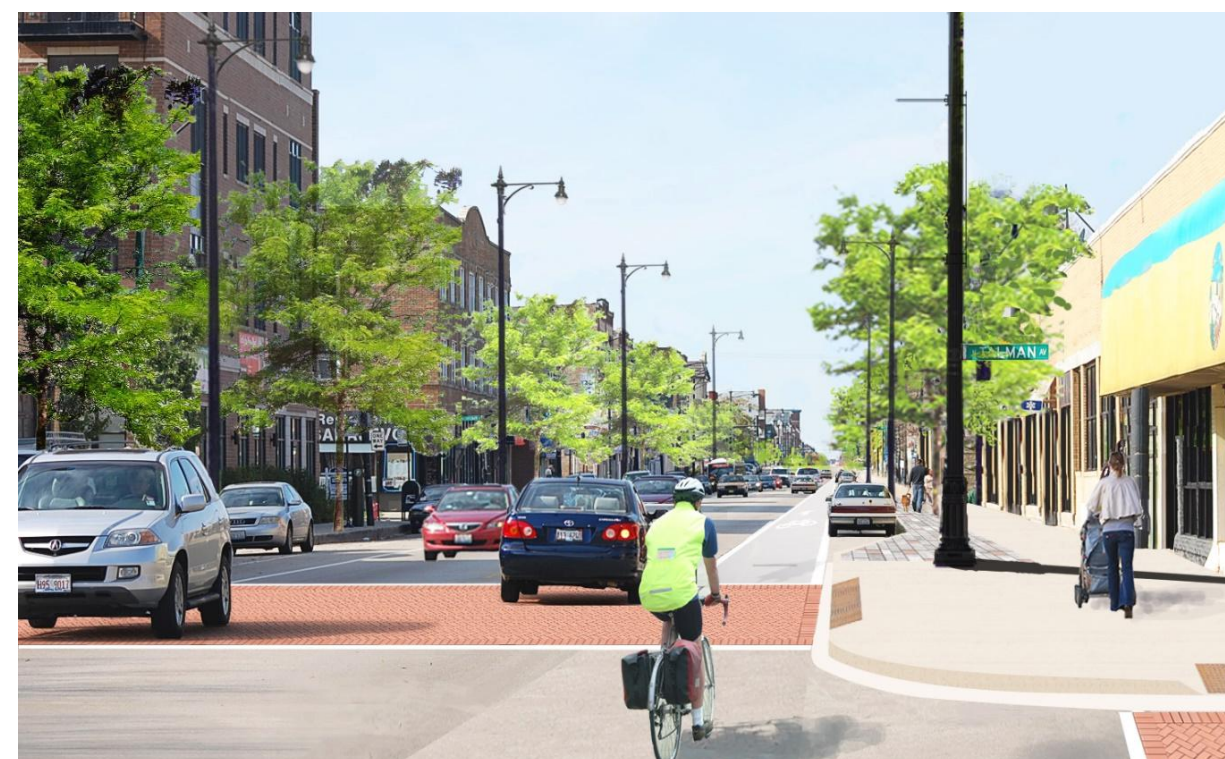

After

- KEY AND TOTAL QTY:
- TREE
  - PRECAST PLANTER
  - BENCH
  - TRASH RECEPTACLE
  - PLANTING BED
  - | BIKE RACK
  - PAVERS
  - STAMPED THERMOPLASTIC
  - T3 LIGHTPOLE ID
  - ★ GATEWAY
  - ≡ CONTINENTAL CROSSWALK
  - ⊙ BUMP-OUTS

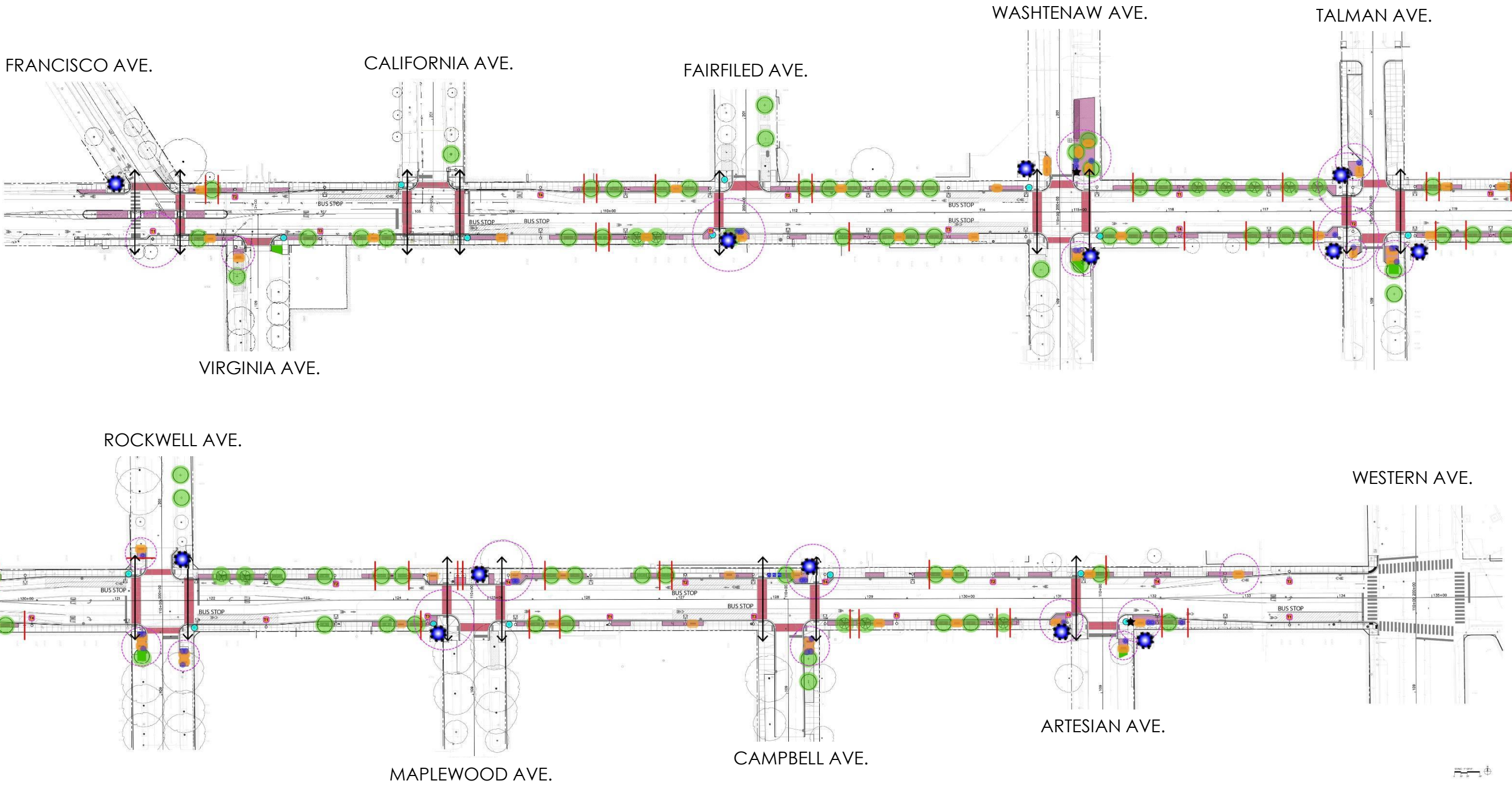

## Section 2: Chicago River to Western Avenue September 29, 2020 Community Meeting #2

# THANK YOU

Please leave any questions or comments on the project website

[HTTPS://TINYURL.COM/LawrenceStreetscape](https://tinyurl.com/LawrenceStreetscape)

You may also leave a message at 312-744-5900  
or email Wade Van Nortwick at [wvannortwick@knightea.com](mailto:wvannortwick@knightea.com)  
Please reference the “Lawrence Ave Streetscape” in your message.

