



61st STREET MASTERPLAN

PUBLIC MEETING #3
SEPTEMBER 20, 2018

Streetscape Masterplan Goals

Develop a plan for the public right of way that addresses:

- Infrastructure improvement needs
- The safety and convenience of all users of the transportation system
- The pedestrian experience and sense of place
- Connectivity throughout the corridor
- Transit needs
- Sustainable best practices
- Long term maintenance

Benefits of a Streetscape Masterplan

A streetscape masterplan is a prioritized and phased implementation document that outlines the proposed right of way improvements, including cost estimates, and potential funding sources.

How does the plan get implemented?

- Federal, state, or city funding
- Leveraging public and private utility upgrades
- Leveraging private development

Project Schedule

- ★ 4/01/2018 – Information gathering session, east
- ★ 6/19/2018 – Information gathering session, west
- ★ TODAY – Recommendations
- ★ Winter 2019 – Final plan



Project Limits

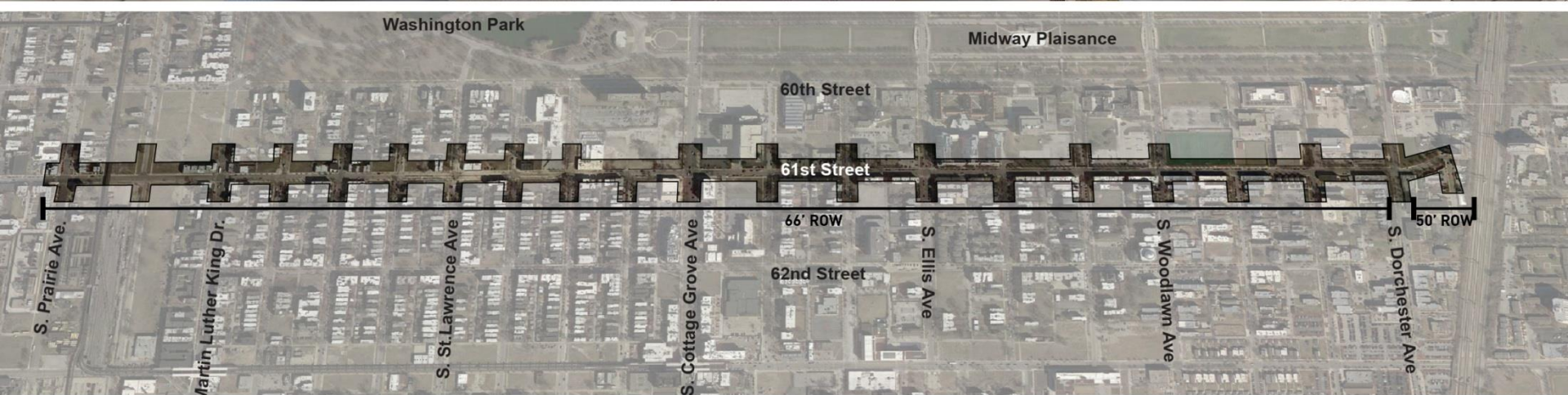

Infrastructure

What we Heard

Infrastructure Elements

Attendees were encouraged to consider the condition of the sidewalk, roadway pavement, stormwater and/or flooding concerns, roadway and pedestrian lighting, and other elements.

Workshop Results

- Wider sidewalk requested on south side of 61st, east of Cottage Grove
- Increase roadway and pedestrian lighting throughout corridor
- Improve drainage and storm water management.
- Left turn signals at key intersections
- Mixed feedback on curb bumpouts
- Consistency requested in sidewalk widths and surfaces along 61st street
- Concern over losing residential, non-permit parking



Infrastructure Analysis

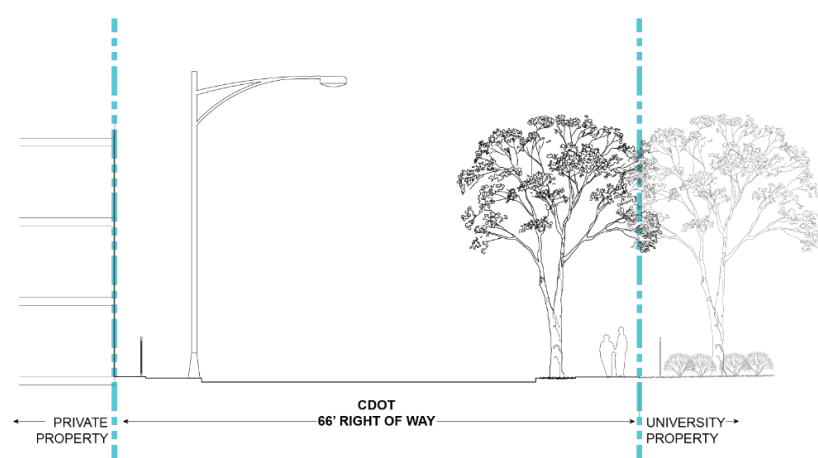
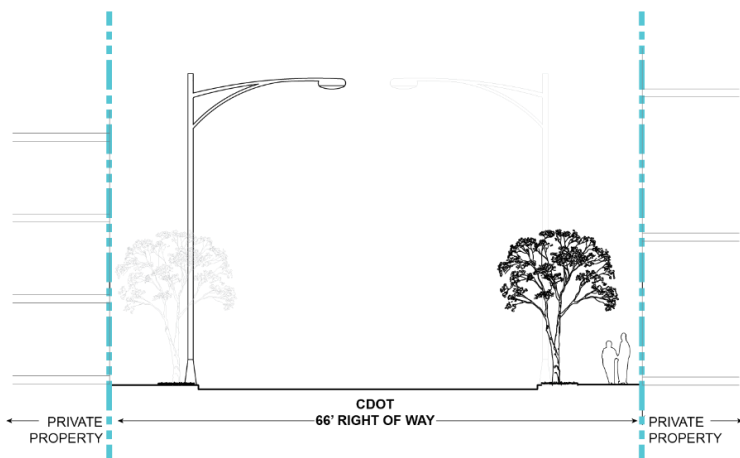
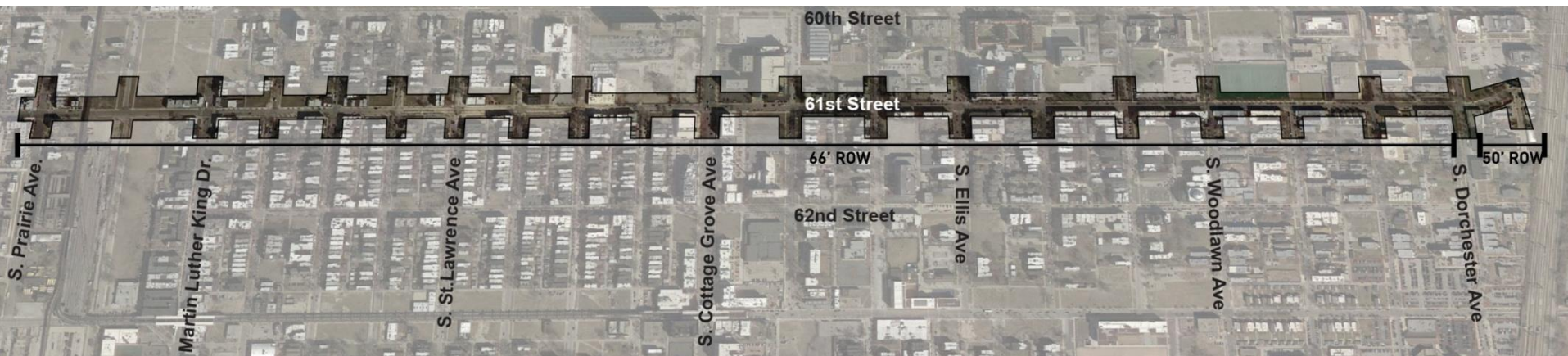

Right of Way

Infrastructure Analysis



PRAIRIE TO COTTAGE GROVE

Infrastructure Analysis

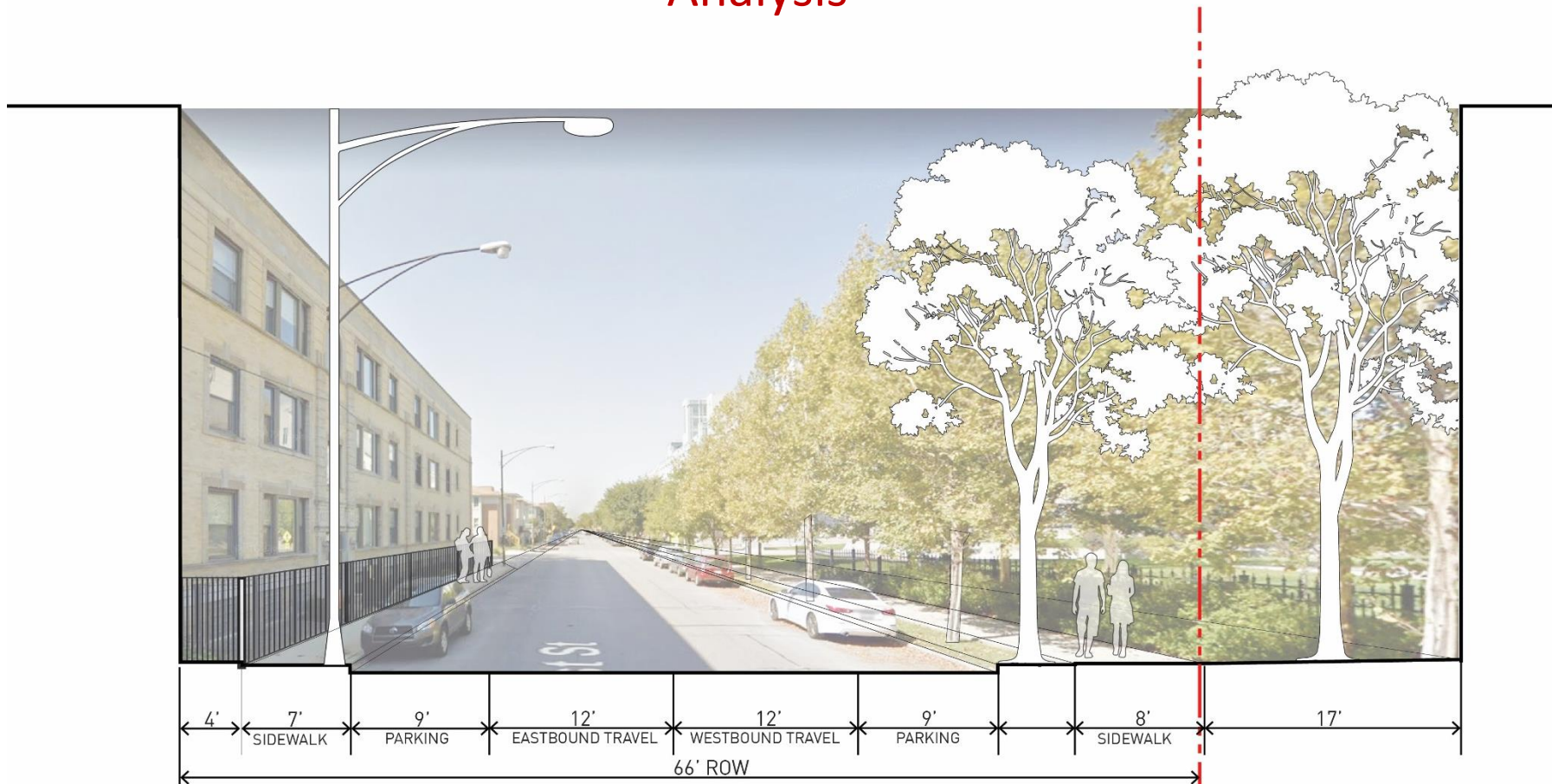

COTTAGE GROVE TO DORCHESTER

Infrastructure

Recommendations

- Widened sidewalk/ parkway
- New LED street lighting with piggyback fixtures



Infrastructure

Recommendations

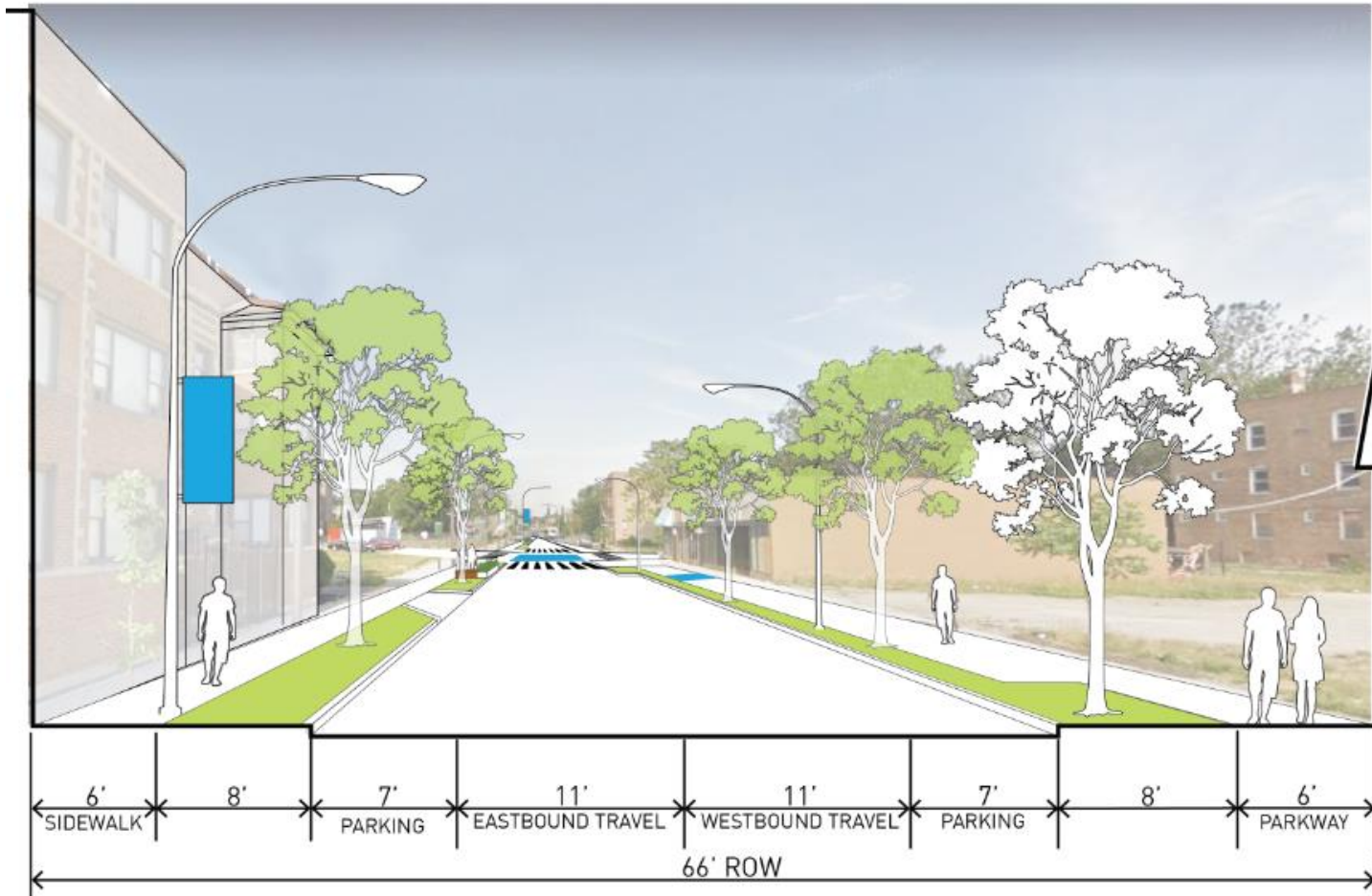

PRAIRIE TO COTTAGE GROVE

Infrastructure

Recommendations

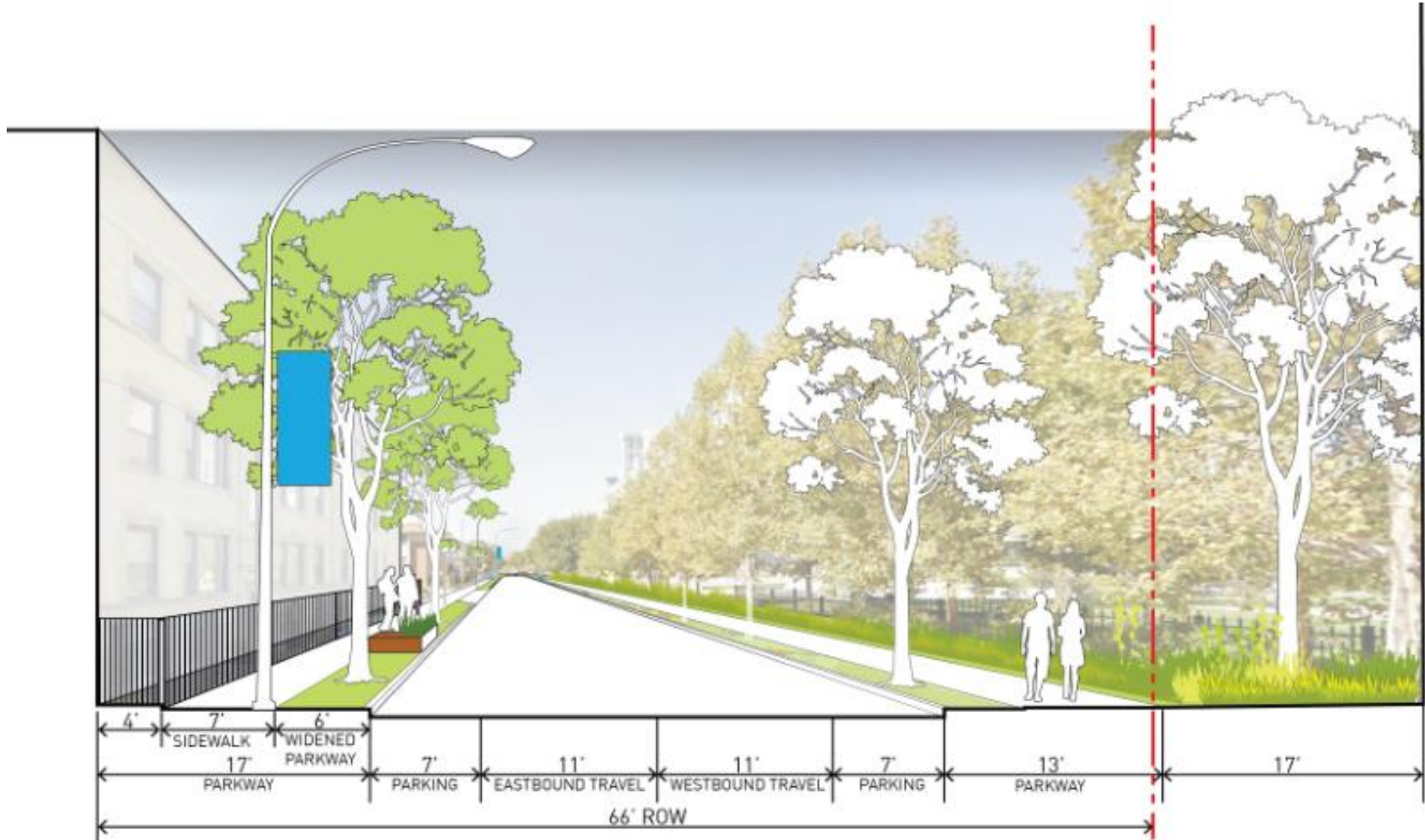

COTTAGE GROVE TO DORCHESTER

Infrastructure Recommendations

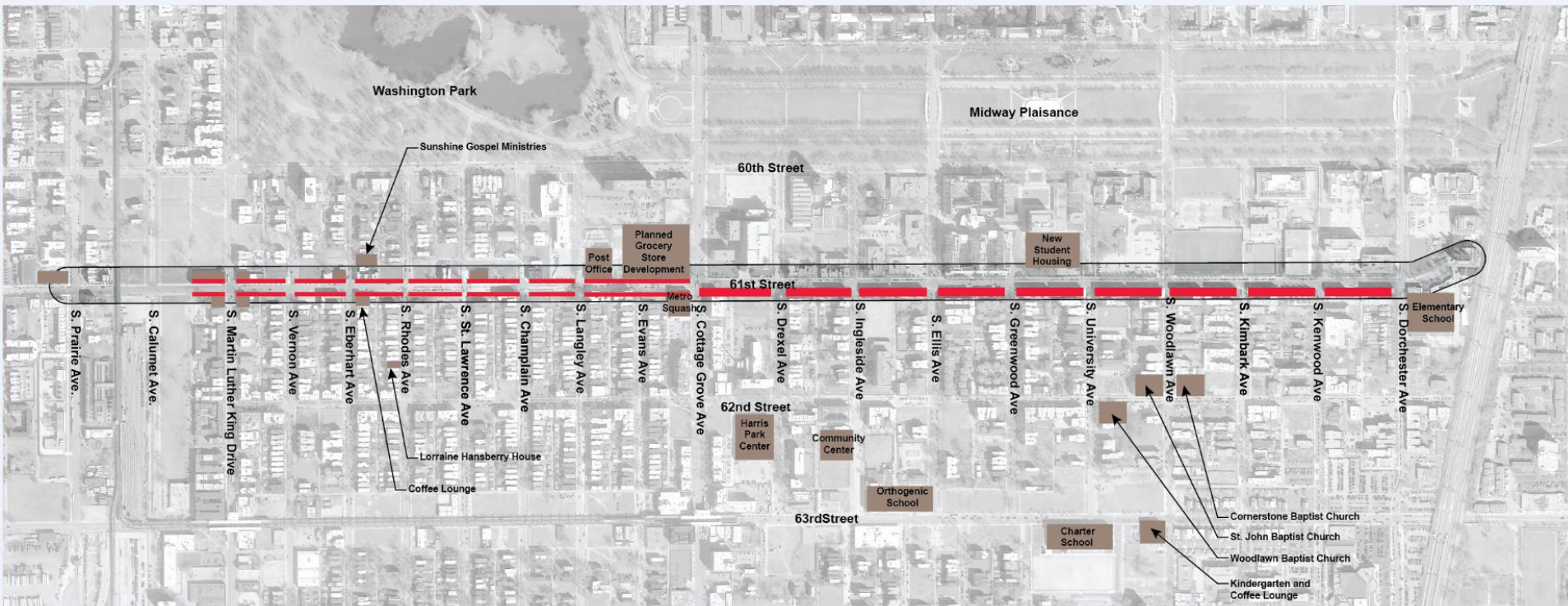

LEGEND

 WIDENED PEDESTRIAN ZONE

Pedestrian Accessibility

What we Heard

Pedestrian Accessibility

Attendees were encouraged to consider crosswalk locations, visibility of pedestrians within the crosswalks, curb ramps at intersections, and pedestrian signage.

Workshop Results

- Slow down traffic
- Increase crosswalk accessibility, safety and visibility
- Improve lighting, signaling and surface reflectivity for crossings
- Mixed feedback on adding more stop signs



Pedestrian Accessibility

Recommendations

- Enhanced intersections
- High visibility crosswalks



Pedestrian Accessibility Recommendations

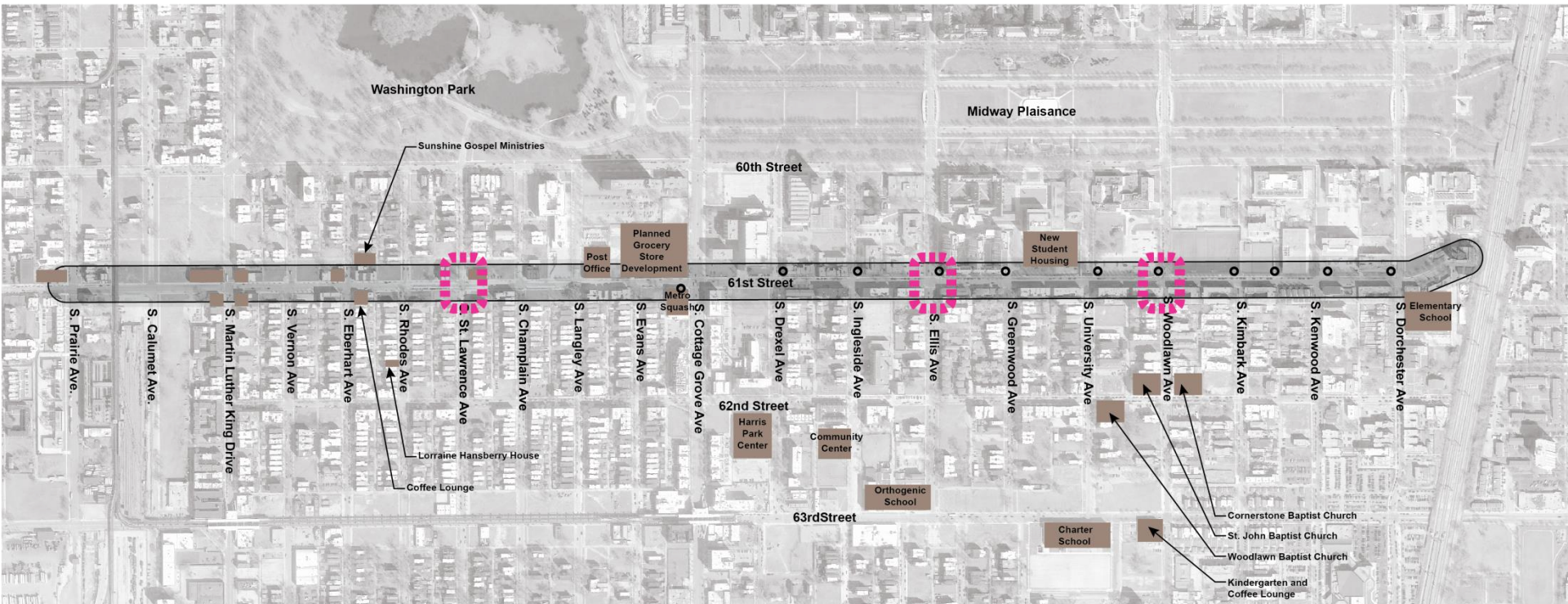

LEGEND



ENHANCED PEDESTRIAN INTERSECTION

Pedestrian Accessibility

Recommendations

- High visibility crosswalks
- Curb extensions at intersections
- Reduced speed limit



Pedestrian Accessibility

Recommendations

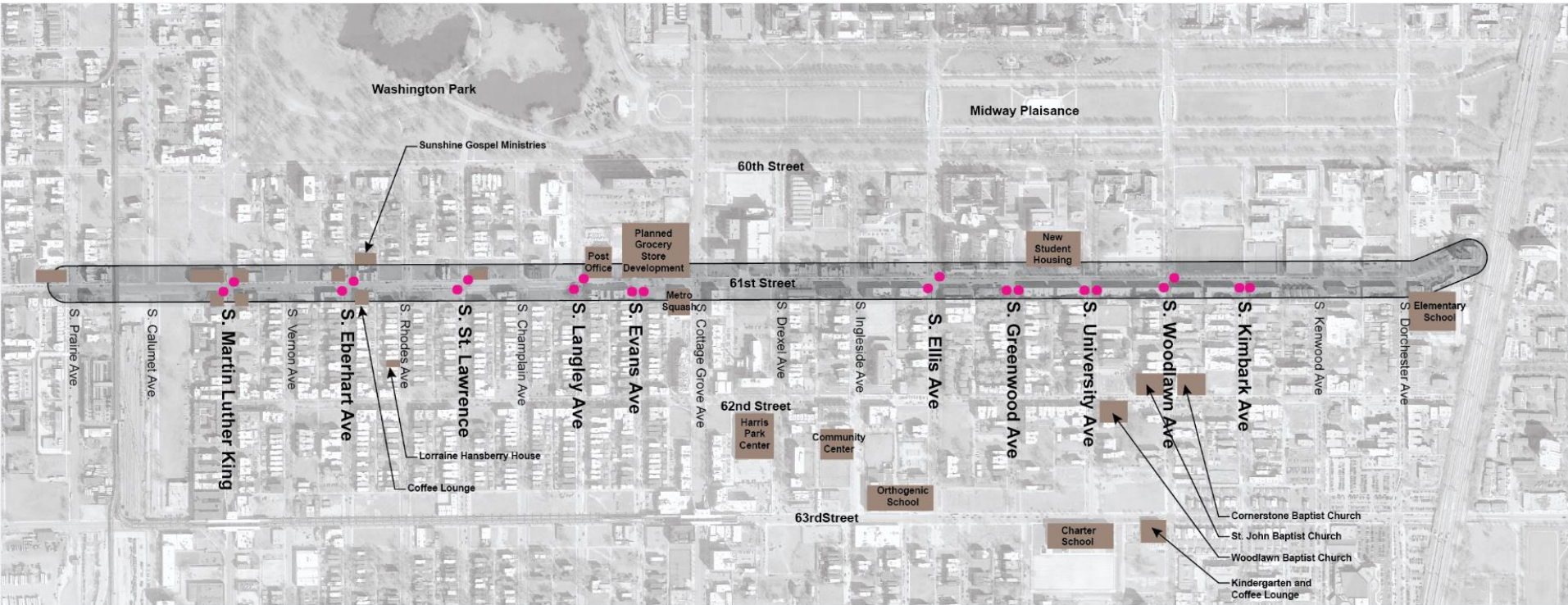

LEGEND

 INTERSECTION WITH BUMPOUTS

Bicycle Accommodations

What we Heard

Bicycle Accommodations

Attendees were encouraged to consider on and off-street bicycle usage, bicycle rack locations, proximity to Divvy stations, crossing locations, and signage to destination points.

Workshop Results

- Mixed feedback on adding bike lanes
- Add bike racks near commercial and public destinations



Bicycle Accommodations

Analysis

BIKE ROUTES



LEGEND



DIVVY STATION



BIKE RACK



BIKE ROUTE

Bicycle Accommodations

Recommendations

- Neighborhood greenway
- Bicycle racks



Bicycle Accommodations

Recommendations

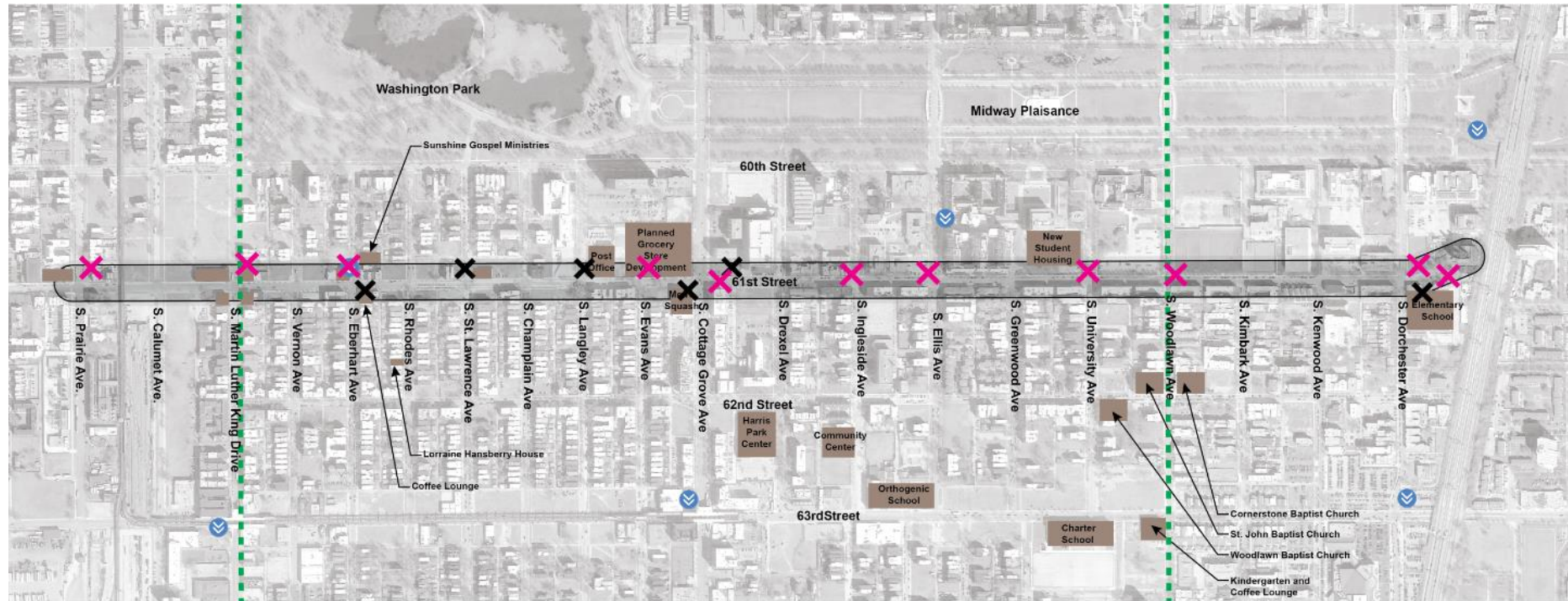

LEGEND

-  DIVVY STATION
-  PROPOSED BIKE RACK
-  EXISTING BIKE RACK
-  BIKE ROUTE

Transit Accommodations

What we Heard

Transit Accommodations

Attendees were encouraged to consider CTA bus stop locations, bus stop benches and shelters, proximity to Metra stations, and signage.

Workshop Results

- Bus shelters requested for key locations west of Cottage Grove
- Benches requested for some bus stops and other key locations



Transit Accommodations Analysis

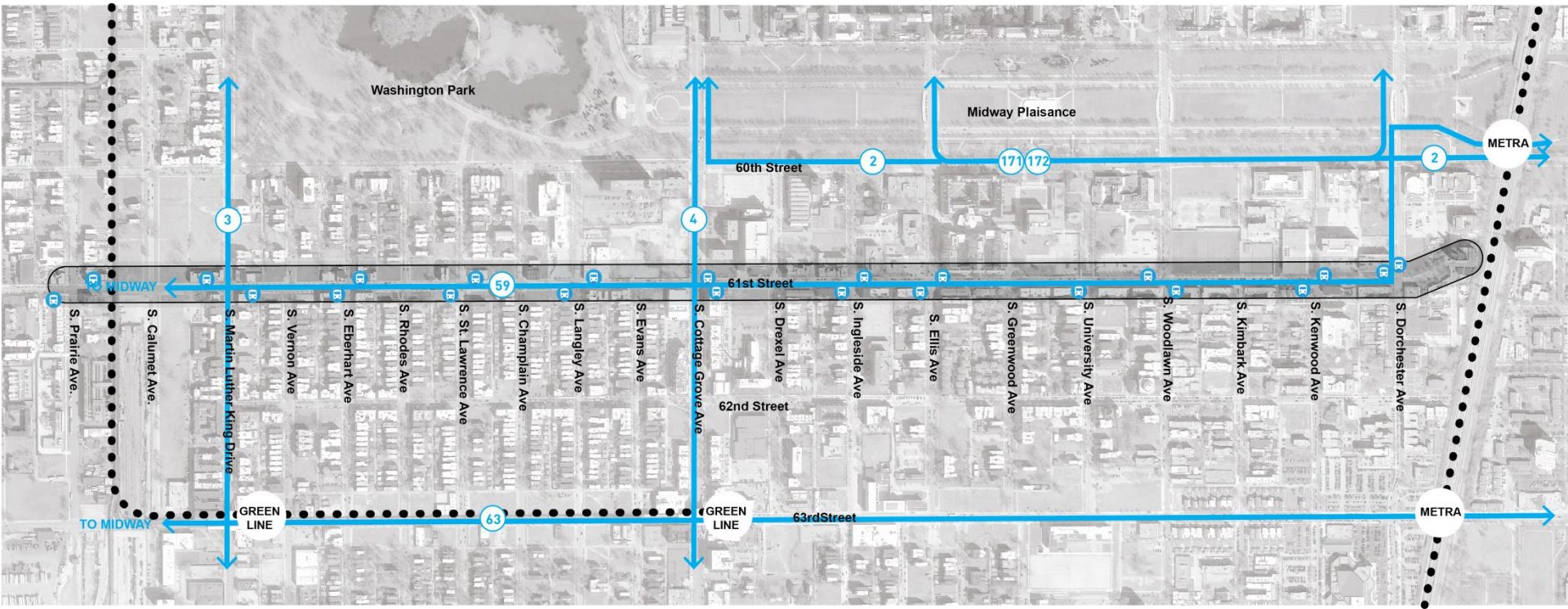

LEGEND

-  CTA BUS STOP
-  CTA BUS ROUTE

Transit Accommodations

Recommendations

- Bus stops locations
- Add benches at stops where possible

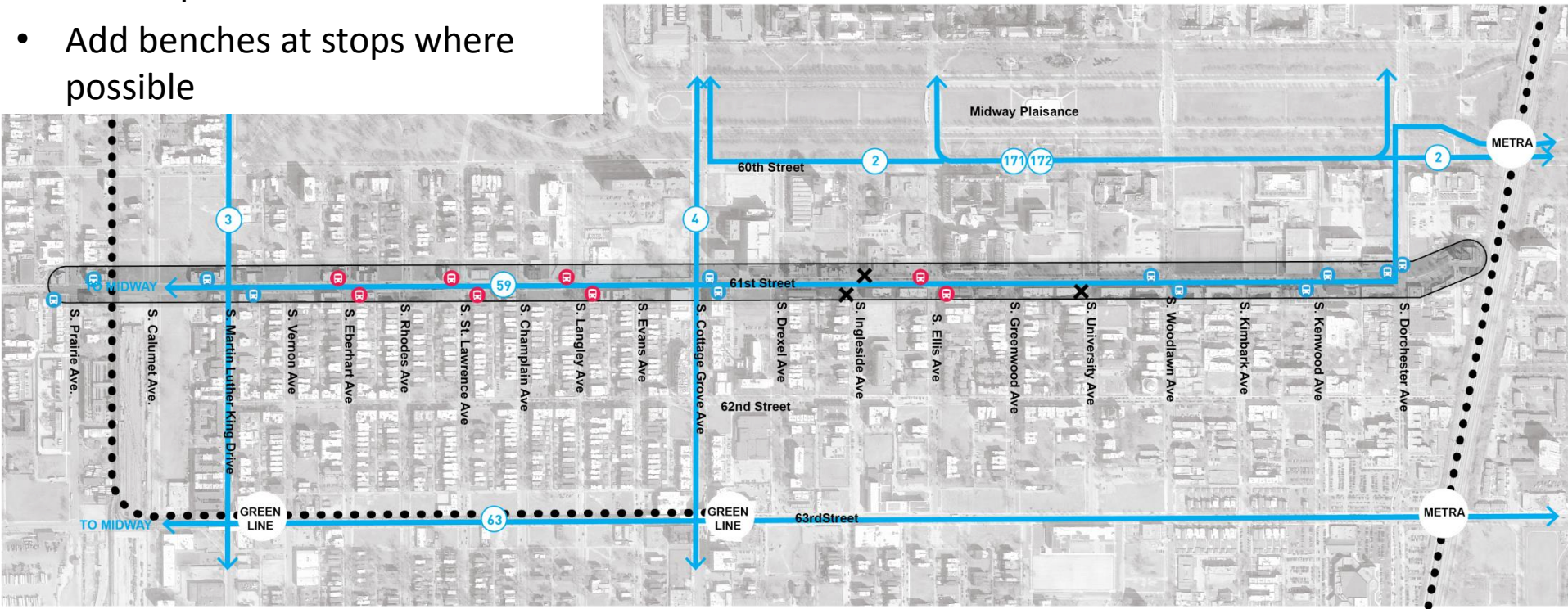

LEGEND

	CTA BUS STOP
	PROPOSED CTA BUS STOP
	CTA BUS ROUTE
	REMOVED CTA BUS STOP

Aesthetics & Landscape

What we Heard

Aesthetics/Landscape

Attendees were encouraged to consider aesthetic elements within the corridor including street trees, the amount of parkway green space, and planters.

Workshop Results

- More trees and maintained landscaping requested
- More trash cans needed
- Incorporate artistic features or appropriate neighborhood identity in furnishings
- Add more murals and public art pieces



Aesthetics & Landscape Analysis

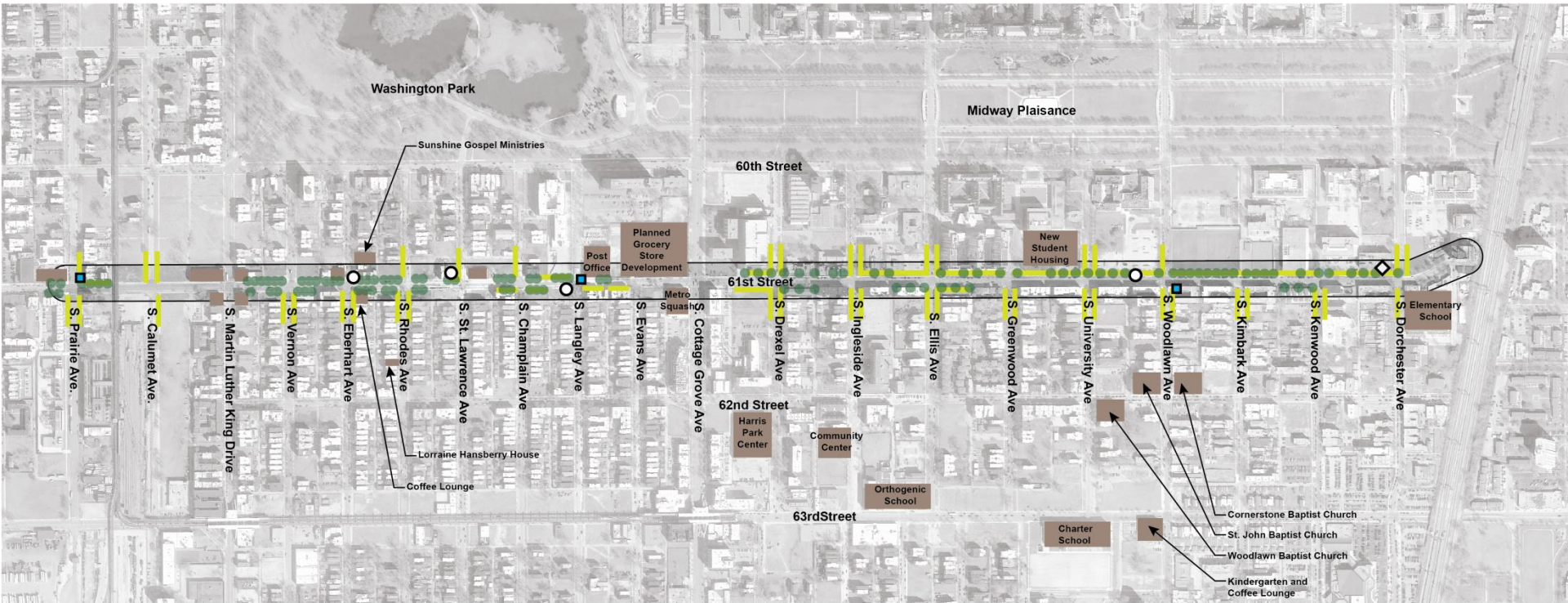

LEGEND

-  PARKWAY
-  TREE CANOPY
-  TRASHCAN
-  BENCH
-  MAILBOX

Aesthetics & Landscape

Recommendations

- Infill of street trees
- Landscaped bumpouts
- Widened parkways
- Trash cans



Community Identity and Placemaking

What we Heard

Community Identity/Placemaking

Attendees were encouraged to consider use of public space for placemaking elements such as public art and promoting Woodlawn community events.

Workshop Results

- Incorporate community history into new and more durable neighborhood identifiers
- Commission local artists to make community focused public art
- Balance the divide between UofC campus and the community and make these boundaries more permeable
- Unite identities of east and west Woodlawn.
- Create "people spots" for residents to gather and relax along the right of way



Community Identity and Placemaking

Recommendations

- Permanent lightpole identifier
- Historic kiosk
- Sidewalk medallions
- People spot

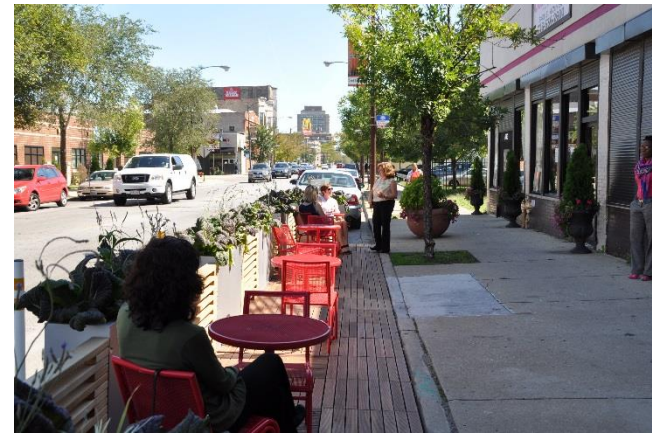

Community Identity and Placemaking

Recommendations

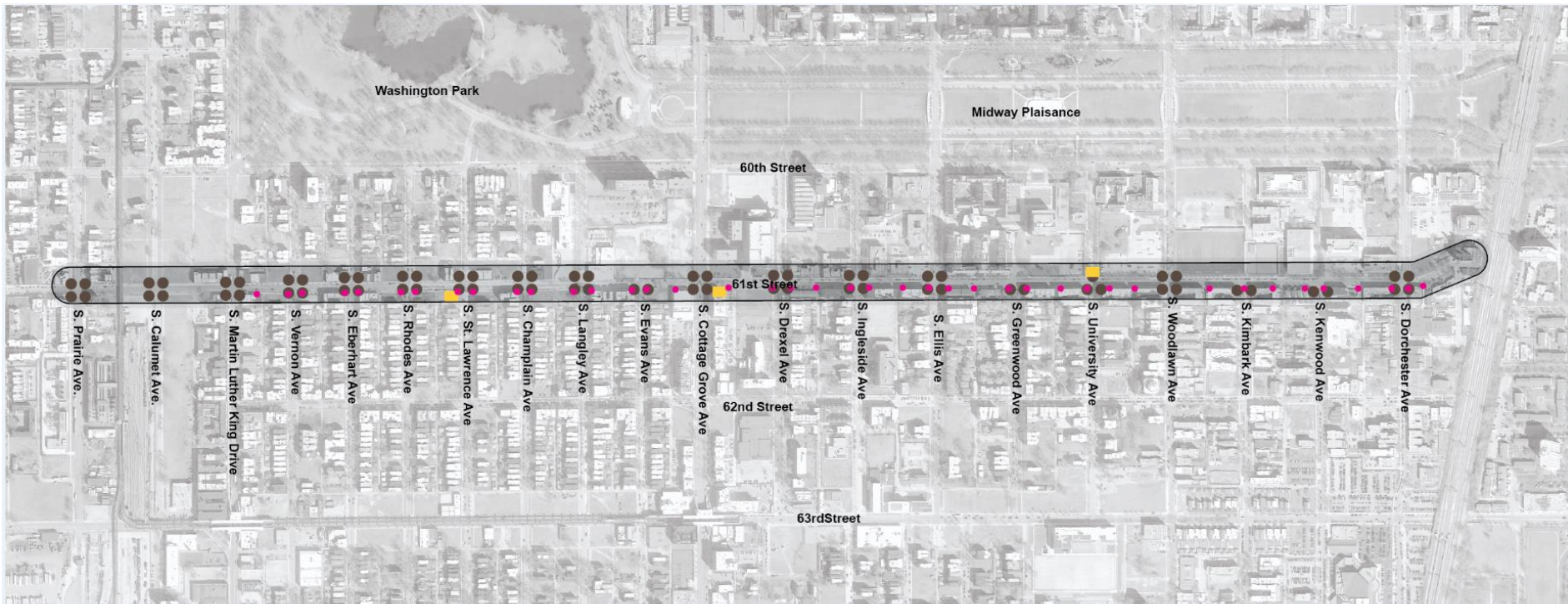

LEGEND

- COMMUNITY LIGHT POLE BANNERS
- SIDEWALK MEDALLIONS
- KIOSK

Additional Comments

What we Heard

Other

Attendees were encouraged to discuss other issues and concerns for the 61st Street Master Plan.

Workshop Results

- Consider traffic patterns for future developments
- Consider public safety after hours

Future Developments

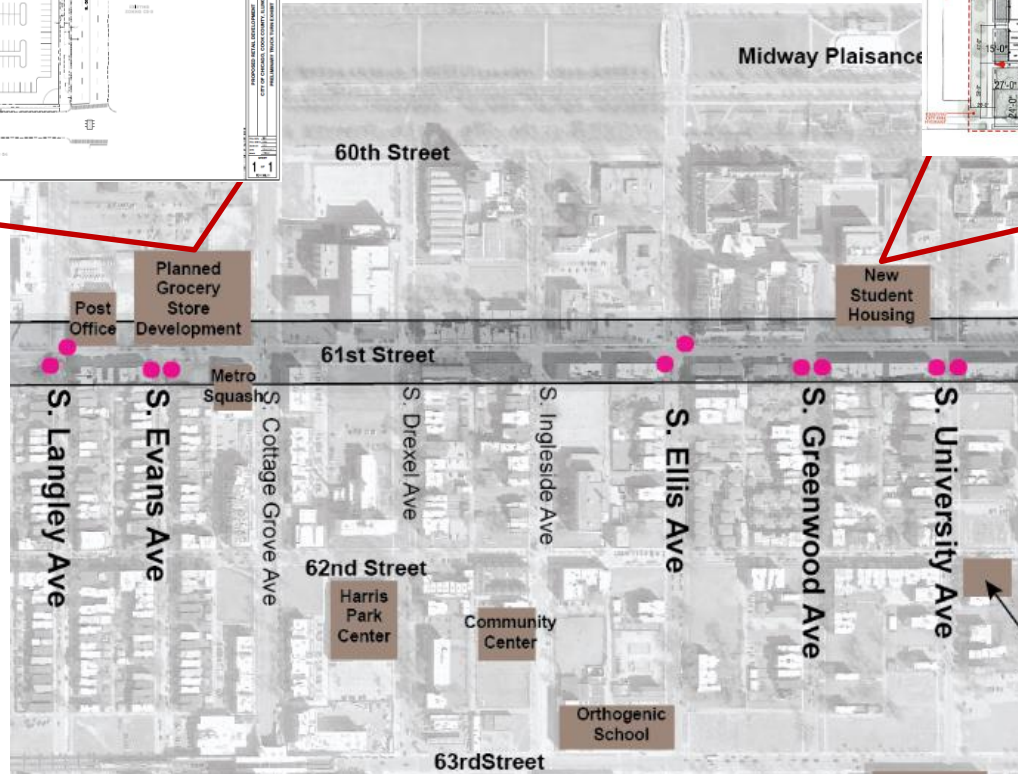
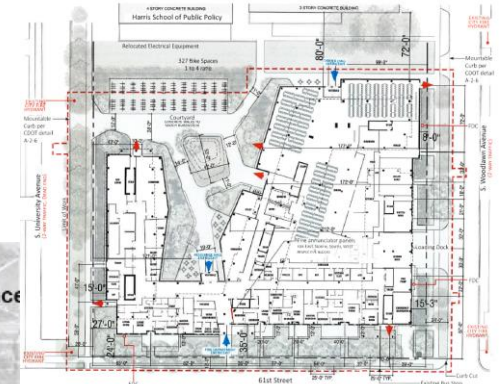
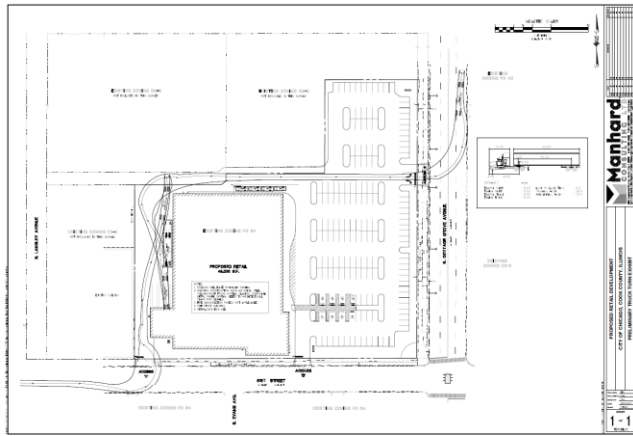

Next Steps

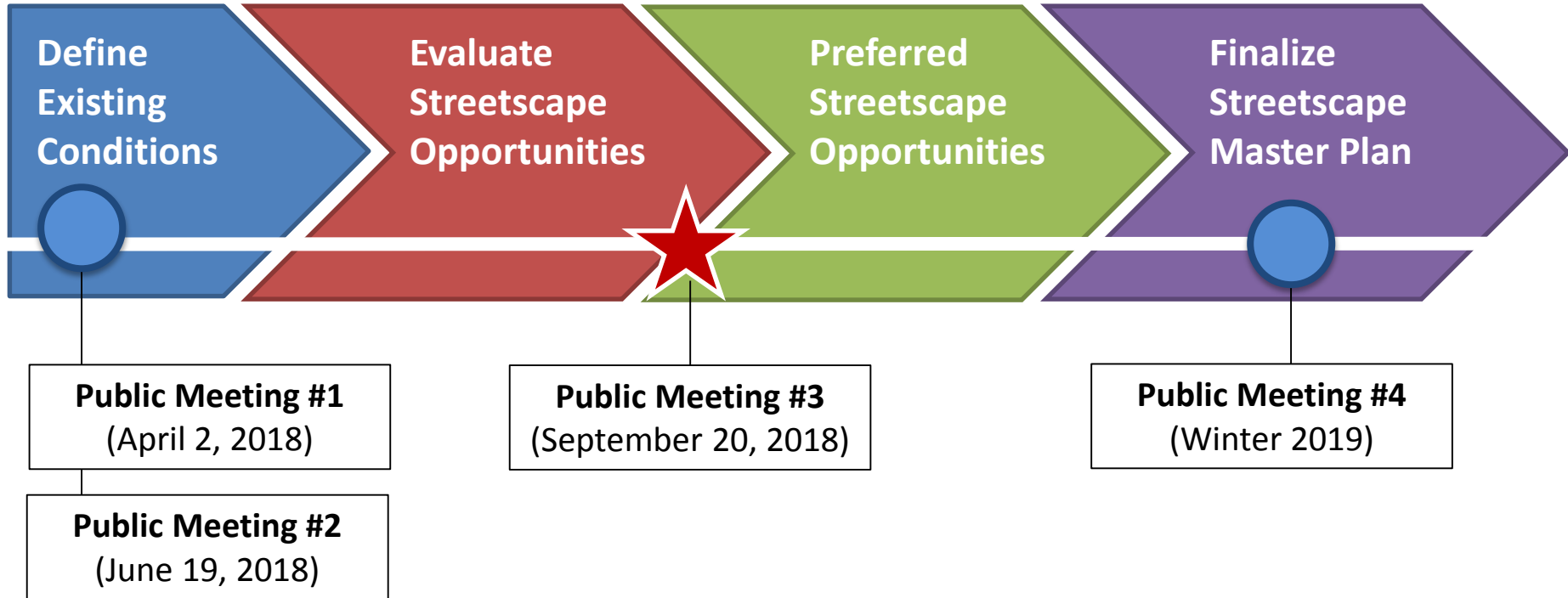

Stay In Touch



Website

www.chicagodot.org

Twitter

[@CDOTNews](https://twitter.com/CDOTNews)

Facebook

facebook.com/CDOTNews